

**Board of Governors
of the
Pennsylvania State System of Higher Education**

Meeting Minutes

166th Meeting
Thursday, June 30, 2011
Boardroom, First Floor
Administration Building
2986 North Second Street
Harrisburg, PA 17110-1201

9:00 a.m.

ATTENDING

Board of Governors:

Mr. Leonard B. Altieri
Ms. Jennifer G. Branstetter (designee for Governor Thomas W. Corbett)
Ms. Marie Conley Lammando
Ms. Sarah C. Darling
Mr. Ronald G. Henry
Mr. Kenneth M. Jarin
Ms. Bonnie L. Keener (via conference call)
Mr. Jonathan B. Mack
Mr. C. R. "Chuck" Pennoni
Mr. Guido M. Pichini (*Chair*)
Mr. Harold C. Shields
Mr. Robert S. Taylor
Secretary Ronald J. Tomalis
Mr. Aaron A. Walton

Representative Matthew E. Baker, Representative Michael K. Hanna, Senator Vincent J. Hughes, Mr. Joseph F. McGinn and Senator Jeffrey E. Piccola were absent.

Office of the Chancellor:

Dr. John C. Cavanaugh (Chancellor)
Ms. Karen S. Ball
Mr. Gary K. Dent
Mr. James S. Dillon
Dr. Peter H. Garland
Dr. Kathleen M. Howley
Mr. Leo Pandeladis
Mr. Arthur C. Stephens

Also in attendance for participation or in support of Committee and Board activities from the Office of the Chancellor: Ginger S. Coleman, Steve R. Dupes, Rita C. Frealing, Audrey J. Guistwhite, Lois M. Johnson, Kenneth D. Marshall, Michael A. Mottola, Georgia K. Prell, Dianne Scaff, Jennifer S. Scipioni, Sylvia E. Thompson, Dean A. Weber, and Eric J. Zeglen.

University Presidents in attendance: F. Javier Cevallos, Robert J. Dillman, Barbara B. Dixon, Michelle R. Howard-Vital, Maravene S. Loeschke, Francine G. McNairy, James D. Moran, Robert M. Smith, David L. Soltz, Greg R. Weisenstein, David J. Werner, and Karen M. Whitney.

Ms. Geraldine M. Jones represented President Angelo Armenti, Jr. and Dr. Jody Harpster represented President William N. Ruud.

Chairman Pichini called the meeting to order at 9:20 a.m.

The Pledge of Allegiance was recited by those in attendance.

Attendance taken at the direction of the Chairman established that a quorum of the Board was present.

REMARKS OF THE CHAIR

Chairman Pichini welcomed everyone to the June 2011 Quarterly Board Meeting.

Chairman Pichini mentioned there were several important items on the agenda. Two of the items are the System and the universities operating budget and setting tuition rates for the 2011/12 academic year. Chairman Pichini said this was one of the most difficult budget cycles the Commonwealth has experienced in a long time and has presented PASSHE with some huge challenges. Chairman Pichini said he has been working with the Chancellor, the Governor and his staff, the university presidents and their staff so we can manage this challenge to continue high quality education for the students.

Chairman Pichini recognized the four new Board members appointed to the Board:

1. Mr. Ronald G. Henry
2. Mr. Robert S. Taylor
3. Ms. Sarah C. Darling
4. Ms. Bonnie L. Keener

Chairman Pichini welcomed Dr. Michael Fiorentino, Jr. who assumes his duties as President of Lock Haven University on Friday, July 1, 2011.

Chairman Pichini thanked Dr. Barbara B. Dixon, Interim President, at Lock Haven University, for her service during the transition period.

Chairman Pichini recognized that Dr. James D. Moran has a new role as Interim President at Edinboro University.

Chairman Pichini welcomed Ms. Jennifer S. Scipioni, President and CEO for the PASSHE Foundation, Inc. Chairman Pichini said we look forward to working with Ms. Scipioni in efforts to help raise funds for our students.

Chairman Pichini mentioned the television program, ABC Extreme Makeover Home Edition, who built a new home for a family of a Lock Haven student who was injured in a gymnastic accident at Lock Haven University in 2006 and is now a paraplegic. Mr. Pichini said that ABC also made some improvements to the student lounge at the Lock Haven University.

Chairman Pichini mentioned the Board met in Executive Session from 4:00 p.m. to 5:15 p.m. on Wednesday, June 29, 2011.

Chairman Pichini noted two resolutions to recommend to the Board for approval.

BOARD ACTION

Mr. Jarin read into the record a resolution honoring Mr. Thomas M. "Doc" Sweitzer.

Mr. Jarin moved **THAT THE BOARD OF GOVERNORS APPROVE THE RESOLUTION.** (Attachment #1)

The motion passed unanimously.

Mr. Walton read into the record a resolution honoring Mr. Paul S. Dlugolecki.

Mr. Walton moved **THAT THE BOARD OF GOVERNORS APPROVE THE RESOLUTION.** (Attachment #2)

The motion passed unanimously.

APPROVAL OF THE MINUTES OF THE APRIL 7, 2011 and APRIL 18, 2011 MEETINGS.

Chairman Pichini noted that the minutes of the April 7, 2011 and April 18, 2011 meetings were distributed prior to the meeting. The Chairman moved **THAT THE MINUTES OF THE April 7, 2011 and April 18, 2011 MEETINGS BE APPROVED.**

The motion passed unanimously.

Chancellor John C. Cavanaugh was called on for his report.

REPORT OF THE CHANCELLOR

Chancellor Cavanaugh welcomed everyone to the Board meeting.

Chancellor Cavanaugh acknowledged Mr. Jarin for his service on the Board. Chancellor Cavanaugh said Mr. Jarin was always there, never too busy, his availability

to the System was incredible, and of all the chairmen he worked with, Mr. Jarin was the best.

Chancellor Cavanaugh mentioned receiving outstanding publicity from the television program, ABC Extreme Makeover Home Edition, who built a new home for a family of a Lock Haven student, Brian Keefer, who was injured in a gymnastic accident in 2006 at Lock Haven University. ABC Extreme Makeover Home Edition also made some renovations to the student lounge in Woolridge Hall at Lock Haven University. Local businesses donated materials and the staff and students donated time to make the improvements. The ABC special with the Keefer family will be aired on September 25, 2011.

Chancellor Cavanaugh acknowledged that the budget is extremely challenging and thanked the Board, Council of Trustees, presidents, faculty, students and staff who worked together on the budget restoration.

Chancellor Cavanaugh indicated to the Board there is still a 112M deficit.

Chancellor Cavanaugh said working with Advocacy groups; PASSHE was able to work with a number of different constituent groups that have some strong benefits. It brought the System closer together with various alumni associations that are becoming more interconnected and the opportunity to work together. This will result in a more effective and organized alumni association statewide with two good benefits; advocacy and to make sure the annual fund is better organized and executed.

Chancellor Cavanaugh mentioned as we move forward we need to discuss and talk about the way things have been done in the past that need to be changed. Chancellor Cavanaugh said the primary way changes will be done is working together with different constituent groups and will be a major focus of our activities as we go forward.

Chancellor Cavanaugh said we need to continue to develop collaborative programs across institutions. On Wednesday, June 29, 2011, Shippensburg University and East Stroudsburg University signed an agreement which will provide Shippensburg University's MBA Program on the East Stroudsburg campus. Chancellor Cavanaugh indicated we must continue to explore ways to share different kinds of programs with the universities and bring better opportunities for the students. With the transfer of credit policies it will be easier for students to bring associate degrees in to our System. Chancellor Cavanaugh said we must look for ways to improve student services particularly those students taking advantage of our on-line programs.

Chancellor Cavanaugh said 2013 is an important year for the System and the Commonwealth. This is the year in which the PennREN Broadband Network will be fully lit. This will bring opportunities for PASSHE in sharing programs and services and opening opportunities for collaboration across all the sectors of education.

The Kinber Organization is responsible for implementing the network consisting of all the sectors of education in the Commonwealth, public and private, as well as the

healthcare community and public media. Chancellor Cavanaugh said this will be a unique opportunity to really look at ways to bring together opportunities and for PASSHE to think about academic programs that we already have and those programs being developed that can really improve giving the prospect of that network.

Chancellor Cavanaugh said he was looking forward to working with Chairman Pichini and that he brought a lot of experience to the Board.

Chancellor Cavanaugh's full report to the Board was sent via e-mail. The report includes highlights of University Accomplishments and Other Noteworthy Activities; Fundraising, Grants and Other Awards; University and Community Partnerships; Student and Faculty Recognition; and Pennsylvania State Athletic Conference Highlights. (Attachment #3)

PUBLIC COMMENTS

Dr. Steve Hicks, APSCUF President, spoke about tuition. (Attachment #4)

Dr. Ken Mash, APSCUF, spoke about tuition. (Attachment #5)

Ms. Lauren Gutshall, Assistant Director of Governmental Relations for APSCUF, read a statement from Ms. Sharon Taylor, Assistant Professor of Theater, at Edinboro University. (Attachment #6)

Executive Session convened at 10:00 a.m.

Executive Session adjourned at 11:40 a.m.

The Board Meeting reconvened at 11:48 a.m.

COMMITTEE REPORTS WITH RELATED ACTIONS

A. Academic and Student Affairs Committee

Mr. Walton presented the report on behalf of the Academic and Student Affairs Committee. The Committee reviewed two information items: Summary of Academic Program Actions: July 1, 2010 – June 30, 2011; and New Academic Programs Approved in the Past Five Years (2006-2011); Enrollment Report.

Mr. Walton acknowledged the Committee had one presentation: PASSHE's Professional Science Master's (PSM) Initiative.

Mr. Walton noted that the Committee had four action items to recommend to the Board for approval.

Mr. Walton moved **THAT THE BOARD OF GOVERNORS APPROVE THE MASTER OF SCIENCE IN INTEGRATED SCIENTIFIC APPLICATIONS DEGREE PROGRAM AT MILLERSVILLE UNIVERSITY OF PENNSYLVANIA.** (Attachment #7)

The motion passed unanimously.

Mr. Walton moved **THAT THE BOARD OF GOVERNORS APPROVE THE MASTER OF SCIENCE IN STRATEGIC STUDIES IN WEAPONS OF MASS DESTRUCTION DEGREE PROGRAM AT INDIANA UNIVERSITY OF PENNSYLVANIA.**(Attachment #8)

The motion passed unanimously.

Mr. Walton moved **THAT THE BOARD OF GOVERNORS APPROVE THE BACHELOR OF ARTS DEGREE PROGRAM IN JURISPRUDENCE AT CALIFORNIA UNIVERSITY OF PENNSYLVANIA.** (Attachment #9)

The motion passed unanimously.

Mr. Walton moved **THAT THE BOARD OF GOVERNORS APPROVE CONTINUATION, THROUGH SUMMER 2013, OF THE EXCEPTIONS FOR THE PROGRAMS LISTED ON THE ATTACHED DOCUMENT, EXCEPTIONS TO THE 120-CREDIT REQUIREMENT, DATED MAY 25, 2011.** (Attachment #10)

The motion passed unanimously.

B. Audit Committee

Mr. Henry presented the report on behalf of the Audit Committee. The Committee reviewed one information item: 2010-11 Annual Report – Office of Internal Audit and Risk Assessment (OIARA).

Mr. Henry noted that the Committee had two action items to recommend to the Board for approval.

Mr. Henry moved **THAT THE BOARD OF GOVERNORS APPROVE THE OFFICE OF INTERNAL AUDIT AND RISK ASSESSMENT'S FISCAL YEAR 2011-12 PROPOSED BUDGET AND STAFFING LEVEL.** (Attachment #11)

The motion passed unanimously.

Mr. Henry moved **THAT THE BOARD OF GOVERNORS APPROVE THE OFFICE OF INTERNAL AUDIT AND RISK ASSESSMENT'S ANNUAL WORK PLAN FOR FISCAL YEAR 2011-12.** (Attachment #12)

The motion passed unanimously.

C. **External Relations Committee**

Ms. Ball presented the report on behalf of the External Relations Committee. The Committee reviewed one information item: Legislative Update.

There were no action items to report.

D. **Finance, Administration, and Facilities Committee**

Mr. Pennoni presented the report on behalf of the Finance, Administration, and Facilities Committee. The Committee had two information items: Fiscal Year 2011/2012 Operating budget Update; and Demolition of Speech and Hearing Center, Edinboro University of Pennsylvania.

Mr. Pennoni noted that the Committee had four action items to recommend to the Board for approval.

Mr. Pennoni moved **THAT THE BOARD OF GOVERNORS INCREASE THE FISCAL YEAR 2011/12 TUITION BY \$218 PER SEMESTER FOR UNDERGRADUATE IN-STATE STUDENTS, INCREASE THE 2011/12 TECHNOLOGY TUITION FEE BY \$58 PER SEMESTER FOR UNDERGRADUATE IN-STATE STUDENTS, AND AUTHORIZE THE CHANCELLOR TO DEVELOP THE 2011/12 TUITION AND TECHNOLOGY TUITION FEE SCHEDULES CONSISTENT WITH BOARD OF GOVERNORS' POLICY 1999-02-A, TUITION.** (Attachment #13)

The motion passed with two abstentions.

Mr. Pennoni moved **THAT THE BOARD OF GOVERNORS APPROVE THE FOLLOWING ALLOCATION OF FUNDS FROM PASSHE'S FISCAL YEAR 2011/12 E&G APPROPRIATION.** (Attachment #14)

Item	Amount
Performance Funding	\$35,851,000
Dixon University Center Academic Programs	\$1,148,000
Office of Internal Audit and Risk Assessment	\$830,296
System Reserve	\$562,815
McKeever Environmental Learning Center	\$302,032

The motion passed unanimously.

Mr. Pennoni moved **THAT THE BOARD OF GOVERNORS APPROVE THE FISCAL YEAR 2011/12 CAPITAL SPENDING PLAN AND SUBMISSION OF THE LISTS OF PROJECTS FOR LEGISLATIVE AUTHORIZATION.** (Attachment #15)

The motion passed unanimously.

Mr. Pennoni moved **THAT THE BOARD OF GOVERNORS APPROVE KUTZTOWN UNIVERSITY'S REQUEST TO PURCHASE PROPERTY AT 15183 KUTZTOWN ROAD, KUTZTOWN, PENNSYLVANIA.** (Attachment #16)

The motion passed unanimously.

E. Human Resources

Ms. Conley Lammando presented the report on behalf of the Human Resources Committee. The Committee reviewed one information item: Presidential Evaluation.

There were no action items to report.

BOARD ACTION

Chairman Pichini moved **THAT THE BOARD OF GOVERNORS APPROVE THE MEETING DATES IN THE ATTACHED BOARD OF GOVERNORS' MEETING CALENDAR.** (Attachment #17)

The motion passed unanimously.

ANNOUNCEMENT

Chairman Pichini announced the next quarterly Board of Governors' meeting is scheduled for October 5 and October 6, 2011 at the Dixon Center in Harrisburg.

ADJOURNMENT

There being no further items of business to come before the Board, the Chairman adjourned the meeting at 12:25 p.m.

ATTEST:

Peter H. Garland
Secretary to the Board



**Resolution Honoring the Contributions
of
Paul S. Dlugolecki**

WHEREAS, Paul S. Dlugolecki provided distinguished service to the Board of Governors of the Pennsylvania State System of Higher Education (PASSHE) since his appointment to the Board in June 2003; and

WHEREAS, Paul S. Dlugolecki served as an adviser to the Chancellor and to the staff of the Pennsylvania State System of Higher Education as academic, financial, administrative, advancement and human resources policies were developed to guide PASSHE within the mission and strategic direction identified by the Board of Governors; and

WHEREAS, Paul S. Dlugolecki contributed significantly to Board discussions and deliberations as chair of the Information Technology Committee, and as a member of the Executive Committee; and

WHEREAS, as chair of the Information Technology Committee, Paul S. Dlugolecki played a leadership role in the development of System wide technology initiatives that have helped to enhance student services as well as the universities' daily business operations;

NOW, THEREFORE, BE IT RESOLVED, that the Board of Governors of the Pennsylvania State System of Higher Education does acknowledge the many fine contributions of Paul S. Dlugolecki to the Board and to the entire Pennsylvania State System of Higher Education; and

BE IT FURTHER RESOLVED, that the Board of Governors extends best wishes to him in all of his future endeavors.

Unanimously adopted by the Board
June 30, 2011

Guido M. Pichini, Chairman



**Resolution Honoring the Contributions
of
Thomas M. Sweitzer**

WHEREAS, Thomas M. Sweitzer provided distinguished service to the Board of Governors of the Pennsylvania State System of Higher Education (PASSHE) since his appointment to the Board in April 2009; and

WHEREAS, Thomas M. Sweitzer served as an adviser to the Chancellor and to the staff of the Pennsylvania State System of Higher Education as academic, financial, administrative, advancement and human resources policies were developed to guide PASSHE within the mission and strategic direction identified by the Board of Governors; and

WHEREAS, Thomas M. Sweitzer contributed significantly to Board discussions and deliberations as chair of the Advancement Committee and then the External Relations Committee, and as a member of the Executive Committee; and

WHEREAS, Thomas M. Sweitzer also has served for nearly six years as a member of the Council of Trustees at Lock Haven University of Pennsylvania;

NOW, THEREFORE, BE IT RESOLVED, that the Board of Governors of the Pennsylvania State System of Higher Education does acknowledge the many fine contributions of Thomas M. Sweitzer to the Board and to the entire Pennsylvania State System of Higher Education; and

BE IT FURTHER RESOLVED, that the Board of Governors extends best wishes to him in all of his future endeavors.

Unanimously adopted by the Board
June 30, 2011

Guido M. Pichini, Chairman



Highlights from the Pennsylvania State System of Higher Education (PASSHE) June 30, 2011

University Accomplishments and Other Noteworthy Activities

Six Pennsylvania State System of Higher Education (PASSHE) universities have been named to the President's Higher Education Community Service honor rolls in recognition of their outstanding community service and volunteering efforts. **Millersville University of Pennsylvania** was one of 114 colleges and universities nationwide included on the Honor Roll with Distinction. PASSHE institutions named to the Honor Roll were **Bloomsburg, Indiana, Lock Haven, Slippery Rock and West Chester Universities of Pennsylvania**. A total of 511 colleges and universities made the list. The Corporation for National Community Service in collaboration with the U.S. Department of Education, U.S. Department of Housing and Urban Development and the President's Council on Service and Civic Participation produce the honor roll listings each year.

A four-member team from **Bloomsburg University of Pennsylvania** received the platinum award for distance education during the IMS Global Learning Consortium held in Long Beach, California. The award, the organization's highest, recognized the team's success using Wimba, now known as Blackboard Collaborate, for online courses in education of the deaf/hard of hearing and speech pathology. The team was headed by Sam Slike, professor of exceptionality programs at BU, and also included Joneen Lowman from Bloomsburg; Pam Berman from the Art Institute of Charleston and a former staff member in BU's Institute for Instructional Technology; and Matt Wasowski, senior manager, Blackboard Collaborate. A total of 30 finalist teams from 15 countries competed for the awards representing the United States, Korea, United Kingdom, New Zealand, Germany, Spain, Portugal, Australia and Singapore.

Cheyney University of Pennsylvania has been named by *G.I. Jobs* magazine as a Military Friendly School for 2012. The top 20 percent of all colleges, universities and trade schools nationwide receive the recognition. A listing of those schools will be included in *2012 Guide to Military Friendly Schools*, which will be published in late September.

Clarion University of Pennsylvania installed Dr. Karen M. Whitney as its 16th president in April. The installation coincided with the university's annual week-long Academic Excellence Series, which honors faculty, staff and students for research and academic endeavors they completed during the 2010-11 year ... **Clarion University** on August 31st will kick off a year-long series of events commemorating the 50th anniversary of the Venango Campus.

Edinboro University of Pennsylvania recently held a ribbon-cutting ceremony for the opening of its new, state-of-the-art Human Services Building that will serve as home to the Nursing Department and Speech, Language and Hearing Department. The facility has been re-named the Jeremy D. Brown Human Services Building in honor of the university's 16th president... **Edinboro University** will launch its School of Business on July 1. The new school will be headed by a longtime Edinboro business faculty member, Dr. Michael J. Hannan, who will serve as dean.

Indiana University of Pennsylvania's Eberly College of Business and Information Technology has maintained its accreditation by the Association to Advance Collegiate Schools of Business (AACSB) International following an internal review, which is required every five years. The College's bachelor's and master's degree programs first achieved accreditation, which is held by less than five percent of colleges and businesses worldwide, in 2001. Founded in 1916, AACSB International is the longest serving global accrediting body for business schools.

Kutztown University of Pennsylvania President F. Javier Cevallos has been elected as the National Collegiate Athletic Association (NCAA) Region 1 representative to the Division II Presidents' Council. The council elects one president or chancellor per region for every 22 institutions in each region. Members work to establish policies and oversee financial and legislative actions for Division II.

Lock Haven University of Pennsylvania students have a renovated game room and lounge in Woolridge Hall, courtesy of *Extreme Makeover Home Edition*. Producers of the popular ABC television program selected the family of LHU student Brian Keefer to receive a new home as part of its ninth season. Brian was injured in a gymnastics accident three years ago and was left paralyzed from the neck down. After missing a year of school, he returned to Lock Haven in 2009 and expects to graduate in May. The renovated game room is the show's way of thanking the university and its students for all they have done for Brian since the accident. The show rebuilt the Keefers' family home and added a separate unit for Brian that includes a therapy pool and other rehabilitation equipment all on one floor. During the week-long construction Brian also had the opportunity to meet and train with Paralympic athletes at the U.S. Olympic Training Center in Colorado Springs ... **LHU** last month held a groundbreaking ceremony commemorating the start of construction on the \$30 million, 686-bed North Fairview

Street student housing complex. The new suite-style residence is expected to be ready for students in approximately 18 months.

Mansfield University of Pennsylvania's marching band, "The Spirit & Pride of Pennsylvania," has been invited to perform during the 2012 Summer Olympics in London. The trip, tentatively set for August 1-9, could also include the opportunity for several other MU ensembles to perform.

Shippensburg University of Pennsylvania's conservation efforts are highlighted in the national publication *Campus Technology*. Efforts by the university's information technology division are featured in the article titled "Lean Green Machines: 7 Sustainability Stars in Higher Ed." ... **Shippensburg University's** weather recording station received the "50 Year Honored Institution Award" from the National Oceanic and Atmospheric Administration "in grateful recognition of 50 years of weather observations in cooperation with the National Weather Service."

Slippery Rock University of Pennsylvania has had its accreditation reaffirmed by the Middle States Commission on Higher Education, which commended the university for the quality of its self-study process and report and for progress to date. The university met all 14 "standards of excellence" considered as part of the review... **Slippery Rock** has been named a "College of Distinction," by StudentHorizons, Inc. SRU is the only public university in Pennsylvania and one of only 23 in the nation to earn the recognition. Four factors are considered in awarding the designation: engaged students, great teaching, vibrant campus communities and successful outcomes... **SRU's** Exercise is Medicine initiative won the inaugural "Exercise is Medicine Active U Challenge" sponsored by the American College of Sports Medicine. The program calls for a shift in the campus and community culture to embrace physical activity as an essential part of human wellness and disease prevention.

West Chester University of Pennsylvania President Greg R. Weisenstein received the General William E. DePuy Award in recognition of his strong support of veterans and for his establishment of an Army Reserve Officers' Training Corps (ROTC) program at the university. The DePuy Award is considered the most prestigious award given by the U.S. Army Cadet Command, the parent organization of the Army ROTC program.

Fundraising, Grants and Other Awards

The **Bloomsburg University** Foundation received a \$1.67 million gift, the largest philanthropic gift in its history, from BU alumni Terry Zeigler, president and CEO of Datacap Systems Inc., and his wife, JoAnn Schultz Zeigler, to create the Zeigler Institute for Professional Development (ZIPD) within the university's College of Business. The institute will focus on professionalism and the interconnectedness of functional business areas. ZIPD has an official launch date of August 29, the first day of the fall semester, and all College of Business students will be required to participate in the program starting in fall 2013... The Foundation also received an anonymous gift of \$100,000 to establish the Dr. and Mrs. Chang Shub Roh and Family Global Awareness Scholarship Fund, which will encourage BU students to prepare abstracts and make presentations

at GASI's annual conferences, held at locations worldwide. GASI is a non-profit academic and professional organization established in 1991 to promote peace by fostering understanding and mutual respect through multicultural and global education. Founder and retired BU Professor Chang Shub Roh leads the organization, assisted by vice chair James Pomfret, also a retired BU professor and current member of the Bloomsburg University Foundation Board of Directors... The **BU Foundation's** "First and Goal," a \$2 million endowed scholarship campaign to benefit BU football, is more than halfway to its goal, thanks in part to a leadership gift of \$500,000 from Jahri Evans, a guard with the New Orleans Saints and former All-American at Bloomsburg. Funds raised through the "First and Goal" campaign will make an additional \$80,000 to \$100,000 in scholarship funds available each year.

The **Clarion University** Civic Engagement Scholarship has been established as the result of a major gift from Al and Jan Lander. As part of the pilot project, three students will receive full tuition scholarships for the 2011-12 academic year. To be considered for the scholarship, a student was required to submit a plan to foster community support in Clarion County ... *Extravaganza 2011*, **Clarion University's** annual black-tie event to honor the Clarion University Alumni Association award recipients, raised \$20,000 to support the Alumni Endowment and the Alumni Association Athletic Endowment, which provide funding for student scholarships.

Twenty-five regional high school students participated in a four-day summer computer security camp presented by the **East Stroudsburg University's** Department of Computer Security and made possible by a \$5,000 grant from the state Department of Community and Economic Development and managed by PASSHE.

Indiana University of Pennsylvania has received \$99,000 from the Alcoa Foundation for research designed to help reduce human error in the workplace. IUP safety sciences professor Dr. Jan Wachter will direct this research, which will investigate current worker-engagement tools and develop models for improving human performance in the workplace.

The **Lock Haven University** Foundation received a gift of \$1 million from the estate of Stephanie Wollock that will support the university's library through an endowed fund. The university is planning to rename the second floor of the library as the "Stephanie A. Wollock Learning Commons." ... The Foundation also received a significant gift of artwork by John Sloan valued at more than \$65,000. The art will be part of the Foundation's permanent collection, and will occasionally be shown in the university's art gallery in the Sloan Fine Arts Building... The **LHU Foundation** held its Second Annual Scholarship Gala at the Durrwachter Alumni Conference Center in April. The event raised more than \$35,000 for scholarships through private gifts by attendees and a silent auction... **LHU** geology professor Md. Khalequzzaman has received a \$10,000 grant from the Degenstein Foundation to continue his research on Marcellus Shale gas well drilling in Clinton County. The Degenstein Foundation has awarded a total of \$42,500 in grants to support Dr. Khalequzzaman's research involving students over the last five years. This year, he will be expanding his research to South Renovo to establish baseline

data for the Hall Run watershed, which is the source for drinking water supply for 540 customers.

A \$10,000 grant will allow two **Shippensburg University** faculty members and the History Department to integrate disability studies into the general education curriculum. The grant from Temple University's Institute on Disabilities was to Dr. Allison Carey, associate professor of sociology and anthropology, Dr. Christine Senecal, associate professor of history and philosophy, and the History Department.

West Chester University of Pennsylvania received a \$200,000 contract through the Troops to Teachers program to manage project services for Pennsylvania and New York. Operated by the U.S. Departments of Defense and Education, Troops to Teachers helps military personnel leaving active service to pursue careers as teachers...The **WCU** Foundation is experiencing a significant increase in the number of donors over last year. As of mid-June, more than 7,500 alumni, parents, friends, corporations and foundations have made gifts, a 17 percent jump from last year.

University and Community Partnerships

Shippensburg and East Stroudsburg Universities of Pennsylvania have signed a letter of agreement that will bring Ship's nationally accredited MBA program to the ESU campus to meet a growing need in that region.

More than 900 **Bloomsburg University** students took part in "The Big Event," a community service project, sponsored by BU's Community Government Association (CGA). BU students tackled winter clean-up projects around town, concentrating on areas where students and local residents live side-by-side and public areas, such as Town Park and the Market Square fountain. Projects included raking, weeding, sweeping, picking up trash and outdoor work at individual residences.

The **Clarion University** Small Business Development Center received the 2010 Small Business Administration Award of Excellence in Training and the Award of Excellence in Capital Formation. The awards are presented annually to economic development partners that provide excellence in service to entrepreneurs and small businesses in the region.

Edinboro University of Pennsylvania held its annual community service day in April, sending hundreds of student volunteers into the community to perform a variety of projects. The event was held in conjunction with "The Big Event, the nation's largest student-led community service project and involved many student organizations and varsity athletic teams.

East Stroudsburg University of Pennsylvania President Robert Dillman and four ESU professors representing the disciplines of computer science, geography, chemistry and physics recently visited the Savannah River National Laboratory (SRNL) in Aiken, South Carolina, to initiate academic research partnerships and student internships similar to those recently established through NASA's Wallops Island Flight Facility in Virginia.

Shippensburg University of Pennsylvania's John L. Grove College of Business is starting an Executive Volunteer Connection Service Partnership in cooperation with the Chambersburg 21st Century Partnership program. This service will connect executive volunteers to area non-profit organizations to provide the necessary expertise for strengthening their capacity to serve their communities... Representatives from **Shippensburg University** and La Rochelle International Business School in La Rochelle, France, signed an intent agreement to promote development of joint studies, research and training activities, and other educational programs of mutual interest. Under the agreement, the two institutions agree to cooperate in the exchange of students for either one semester or an entire academic year. La Rochelle is about three hours southwest of Paris.

Student and Faculty Recognition

Dr. Emily Sweitzer, chair of the Department of Justice, Law and Society at **California University of Pennsylvania**, has been chosen to serve as a master trainer for *One on One, Connecting Cops & Kids*, a national program designed for law enforcement officers. The program raises awareness of the impact that police officers' presence, authority and actions can have on children of different ages, and it demonstrates how officers' understanding of child development enhances both their effectiveness and safety.

A team of four students from **Clarion University of Pennsylvania's** chapter of the Society for the Advancement of Management (SAM) took first place in the business plan competition at the 27th Annual Same Case Competition held in to Orlando, Florida. Winning team members were Lauren Eonta, Ryan Ortyl, Jon Catanzarita and Peter Baschnagel. It marked the first time in 12 years of competing that a team from Clarion won the competition... Four **Clarion University** students received full scholarships to attend the Chautauqua Writers' Festival earlier this month. They are Hilah Panichelle of Crabtree, Hannah Mitchell of Slippery Rock, Natalie Phelps of Titusville and Jayna Fox of Punxsutawney. The festival is a four-day, intensive writers' retreat in which participants study with nationally recognized, award-winning poets, nonfiction and fiction writers... Rich Herman, who is in his 31st year as the sports information director at **Clarion University**, earned two prestigious College Sports Information Director of America (CoSIDA) national awards: induction into the CoSIDA Hall of Fame and the 2011 Warren Berg Award.

Site Life Marketing System, a company founded by **East Stroudsburg University of Pennsylvania** graduates Austin Houser of Palmyra and Michael Rosol of Nazareth, took second place out of a field of 18 entries in the Ninth Annual Great Valley Business Plan Competition held last month at Wilkes-Barre. Site Life Marketing System is one of seven businesses housed in the ESU Business Accelerator, a business incubator that provides start-up resources and assistance to local and regional companies during their critical development periods.

Members of **Kutztown University's** Applied Investment Management (AIM) class participated in the Student-Managed Portfolio Competition at the Global Asset Management Education Forum at Quinnipiac University and for the first time in KU's

history, won the "Best Value Portfolio" award, the most competitive prize category. More than 900 college students participated in the forum... **KU** associate professor Dr. CJ Rhoads was honored by the Greater Reading Chamber of Commerce with the Athena Award. The award honors individuals who strive toward the highest levels of professional accomplishment and have devoted time and energy to their community in a meaningful way, and who also open paths so that others may follow. In 2009, Rhoads was named one of Pennsylvania's Best 50 Women in Business by Pennsylvania Governor Rendell's office.

Lock Haven University of Pennsylvania sophomore Christopher W. Smyth received the Hollings Scholarship from the National Oceanic and Atmospheric Administration (NOAA). The Ernest F. Hollings Undergraduate Scholarship provides up to \$16,000 in tuition over the next two academic years and a summer internship in marine biology during the summer of 2012 worth another \$6,500. Smyth also was selected to receive the Department of Biology's marine biology scholarship this summer for study at the Marine Science Consortium at Wallops Island, Va. ... **LHU** chemistry major Eric Driscoll is the recipient of a National Science Foundation REU (Research Experience for Undergraduates) Scholarship. He has been accepted to Harvey Mudd College in Claremont, California, where he will work with Dr. Hal Van Ryswyk on his dye sensitized solar cell research... Jacob Cox also received the NSF REU scholarship, and will spend the summer doing research at Pennsylvania State University, where he will work on a project related to the deterministic assembly of nanowires and sheets... The National Council of the Society for Collegiate Journalists (SJC) named the **Lock Haven University** chapter the 2011 winner of the McDonald Award for Outstanding Chapter. The Society for Collegiate Journalists is a national honorary society for collegiate mass communications, journalism and other media... Dr. Kathleen Allison, associate professor in the Department of Health Science at **LHU**, was among the first to earn the certification as a Master Certified Health Education Specialist (MCHES). The newly created advanced-level certification awarded by the National Commission for Health Education Credentialing, Inc., signifies that she has met the national standards for individual health education practitioners.

Mansfield University of Pennsylvania professor Kenneth Sarch last month performed the world premiere of Panamanian composer Narcisco Garay's *Sonata* and *Panamanian Suite* as a featured concert in the Saint Malo Music Festival held in the National Theater in Panama City. Sarch is a frequent visitor to Panama. In January, at the invitation of the Panama National Concert Association, he taught and conducted the orchestra at the 26th Music Camp Festival in Panama City. That marked the eighth time Sarch had been invited to be guest conductor.

Millersville University of Pennsylvania senior Kimberly Landis was named the national student of the year in Alpha Epsilon Rho, the nation's oldest broadcasting society. She received the recognition at the 69th annual convention of the National Broadcasting Society-Alfa Epsilon Rho in Los Angeles... **Millersville University** Theatre received numerous certificates of merit from the Kennedy Center American College Theatre Festival, Region Two. "Earth and Sky" and "Heathen Valley" were acknowledged and both students and faculty were recognized.

Shippensburg University of Pennsylvania professor Thomas P. Verney is the recipient of a Fulbright Scholarship award to study in Wroclaw, Poland. Dr. Verney is a member of the international management faculty in the John L. Grove College of Business... **SU's** student chapter of the Society for Human Resource Management (SHRM) has earned a 2010-11 Superior Merit Award from the national organization as recognition of its outstanding activities and programs. The annual award program, started in 1972, is to develop more effective student chapters and to promote outstanding activities and projects by student chapters in basic student chapter requirements, chapter programming and professional development of members, support of the human resource profession, and partnership with SHRM... **Shippensburg University's** Supply Chain Management Team competed at the 2011 Council of Supply Chain Management Annual (National) Conference Pittsburgh College Challenge and took first place.

Slippery Rock University of Pennsylvania chemistry major Christine Lundblad of Pittsburgh has been accepted into the doctor of philosophy program in inorganic chemistry at the University of Oxford... **SRU's** Brian Fusco was drafted by the Minnesota Vikings in the sixth round of the 2011 NFL Draft... Seven **SRU** safety management majors received \$15,600 in scholarship aid from the American Society of Safety Engineers Foundation, making SRU the top university in the nation both in number of students honored and total dollars awarded.

West Chester University of Pennsylvania biochemistry major Cassie Callmann was named an Amgen Scholar. This opportunity allows her to spend the summer conducting research at the University of California, San Diego. The Amgen Scholar Program received more than 4,000 applications for the summer term, and selected fewer than 300 undergraduates nationwide... **WCU** sophomore Michael Jendzurski has been named one of the inaugural Campus Compact Newman Civic Fellows for his community engagement. Nationwide, only 135 student leaders received this honor.

Pennsylvania State Athletic Conference Highlights

Pennsylvania State Athletic Conference student-athletes enjoyed a banner year for their academic performance, with 19 CoSIDA/Capital One Academic All-America® citations being awarded during the 2010-11 academic year. Ten of the 19 were named to their respective first teams, tying the conference record set last year. Nine schools had at least one Academic All-American. The PSAC had four members of the Academic All-America football team—all on the first team – and three on the women's track & field cross country teams – one on the first team.

Kutztown University of Pennsylvania's Melissa McQuade became the first women's basketball Academic All-American from the PSAC since 2003-04. Six of this year's Academic All-Americans were repeat winners from last year: Jessica Bennett (**West Chester** - women's soccer), Bryan Boyce (Mercyhurst - football), Matt Freed (**East Stroudsburg** - football), Vicki Bendus (Mercyhurst - women's at-large), Jennifer Harpp (**Slippery Rock** - women's track & field/cross country) and Neely Spence (**Shippensburg**

- women's track & field/cross country). Harpp made first team All-American for the first time in her career after making the second and third teams the two prior seasons.

East Stroudsburg University of Pennsylvania pitcher Jeremy Gigliotti was selected by the San Diego Padres in the 19th round of the Major League Baseball draft held earlier this month. Gigliotti of Saylorsburg is the third player in ESU history to be drafted. He was the 2011 PSAC East Pitcher of the Year and a first team All-PSAC East selection, finishing his senior season with a 1.04 ERA in 69 innings of work and leading Division II in ERA for most of the season.

Shippensburg University of Pennsylvania was chosen by the NCAA for featuring the PSAC's top community engagement activity during the 2010-11 academic calendar. SU's MentorSHIP program and Kid's Night Out event were among 17 initiatives considered for national recognition. Shippensburg's Student-Athlete Advisory Committee (SAAC) developed the MentorSHIP Program to create a positive relationship with the youth of the Shippensburg community. MentorSHIP involved an elementary school student being paired with an SU student-athlete who made weekly contact by phone, letter or e-mail. Student-athlete mentors represented all athletic teams at Shippensburg while the mentees were third graders from either James Burd or Nancy Grayson Elementary School. Kid's Night Out occurred in December 2010. The children were invited to attend along with siblings and friends to partake in a free night of games and activities from Heiges Field House.

The **Bloomsburg-IUP** football game scheduled for this upcoming season has been selected to be televised on the CBS Sports Network as a part of the NCAA Division II television package. This package marks the sixth year of Division II and CBS Sports Network's partnership to provide Division II schools live national television exposure for their football and basketball programs. The game will begin at 8 p.m., September 15, at IUP's Miller Stadium.

Below is a summary of individual and team champions crowned during the winter sports season in the Pennsylvania State Athletic Conference (PSAC):

Men's Basketball – PSAC Champion: IUP became the second program since 1983 to win back-to-back league titles. NCAA Regional: IUP lost to No. 1 West Liberty in regional final. Slippery Rock and Mansfield also qualified.

Women's Basketball – PSAC Champion: Edinboro. Second PSAC championship and first since 1990. California played in championship game for 11th straight season. NCAA Regional: Cal U. lost in regional semifinal; Edinboro and Millersville lost in first round.

Men's Indoor Track and Field – PSAC Champion – Shippensburg. NCAA Championships: Shippensburg finished 9th; IUP, 15th. Eight All-America finishes, including IUP's Nafee Harris in the long jump and the Shippensburg distance medley relay team, who won national titles.

Women's Indoor Track and Field – PSAC Champion: Shippensburg won second straight league title. NCAA Championships: Shippensburg finished 11th; East Stroudsburg, 22nd. Five All-America finishes, including Shippensburg distance medley relay team, which won national title.

Men's Swimming – PSAC Champion: West Chester won 13th straight PSAC league, current best streak for all PSAC sports. NCAA Championships: Clarion finished 16th. Four All-Americans (top 8) from PASSHE schools. Clarion's Logan Pearsall won 3-meter springboard diving national title.

Women's Swimming – PSAC Champion: West Chester won 5th straight league title. NCAA Championships: West Chester finished 4th; Clarion, 8th. Twenty-four All-America finishes. Clarion's Kayla Kelosky won national titles in 1- and 3-meter springboard and Cal U's Melissa Gates won 50-meter freestyle. Clarion's Kaitlyn Johnson won seven All-America citations, earning the maximum 28 for her career.

Wrestling – PSAC Champion: Clarion won league title for first time since 1994. NCAA Division I Championships: Edinboro's Chris Honeycutt finished fifth and was the PSAC only All-American. NCAA Division II Championships: Two All-Americans. Shippensburg's Chris Kochinsky finished 4th at 125 and Kutztown's John Paukovits, 6th at 149. Shippensburg finished 22nd overall and Kutztown, 24th.

Below is a summary of individual and team champions crowned during the spring sports season in the Pennsylvania State Athletic Conference (PSAC):

Baseball – PSAC Champion: Mercyhurst. NCAA Regional: Millersville defeated Mercyhurst in championship round. East Stroudsburg also qualified.

Softball – PSAC Champion: IUP won its first ever league title. NCAA Regional: IUP defeated Bloomsburg. California, Kutztown, Lock Haven and Shippensburg also qualified..

Men's Outdoor Track and Field – PSAC Champion: Shippensburg won third straight league title. NCAA Championships: IUP finished 19th. Eleven All-America finishes.

Women's Outdoor Track and Field – PSAC Champion: Shippensburg won second straight league title. NCAA Championships: Slippery Rock finished 12th; Shippensburg, 13th. Eleven All-America finishes. Shippensburg's Neely Spence (5,000 meters) and Slippery Rock's Whitney Henderson (high jump) won national titles in their events.

Women's Lacrosse – PSAC Champion: Lock Haven won third straight league title. NCAA Championships: West Chester defeated Lock Haven in opening round. WCU lost to Limestone in national semifinals.

Men's Tennis – PSAC Champion: Kutztown won third straight league title. NCAA Championships: Kutztown, Bloomsburg and Millersville qualified.

Women's Tennis – PSAC Champion: California. NCAA Championships: California, Slippery Rock and IUP qualified.

Men's Golf – NCAA Super Regional: IUP finished second and qualified for national championships. Clarion's Jared Schmader won regional medalist honors and qualified for nationals as an individual.

Women's Golf – NCAA Super Regional: California finished second and qualified for national championships. NCAA Championship: CalU finished seventh, the best ever for a PSAC program. Dianne Luke became the school's second ever All-American with a sixth place finish in individual standings.

Remarks from Dr. Stephen Hicks, President of APSCUF

Thank you, Mr. Chair, for this opportunity to speak and congratulations on your recent election. You step into a line of large footprints to follow.

I am here today for my annual message with my annual plea. For those of you who have been here the previous three years, you will recognize the same plaintive voice and many of the same, hard facts.

You need to raise tuition and you need to raise it to a level where these presidents can return to their campuses and unleash the power of their personnel and provide our students with the quality education that Act 188 mandates for us.

You worry about how tuition increases will harm students; so do I. I have spent all spring lobbying to turn around the Governor's destructive budget proposal, speaking many times on the Capitol steps, pleading for the legislature to listen. Then lobbying the Senate to provide more than the House's better, but still damaging, proposal. I have talked again and again to students who have said that a significant tuition increase will make returning difficult, if not impossible. But PHEAA has changed their rules in the last week so our students can receive more aid, so maybe those worried about not coming back will be helped, as they should be.

You have done a great job the last six years on tuition, to the point of arguably starving the universities. We have the lowest tuition increases in the country for a public system over that time, and have gone from above the national average in tuition to below it by some \$600. Compared to our regional competition, our tuition is \$2600 below their average. And our nearby competitor's tuition is more than double ours.

We are the lowest cost alternative. But we can't be the lowest quality. Not raising tuition to fill this gap will mean empty classrooms — ask these presidents, all of whom have faculty contracts and empty classrooms contingent on your decision today. You signed onto the Lumina degree goal program at your last meeting; not filling those classrooms will make it harder for students to graduate.

And we don't have the facilities to expand class size much more. And no one thinks constant expansion of class size doesn't diminish the education we provide. There's a limit to that if we want to maintain our quality mandate.

So, please, today, provide full funding. In two weeks Penn State will announce a dollar increase that will probably dwarf what you do today, making it even less affordable to Commonwealth families. So, again, I plead, vote for an increase that fills most of the \$90 million the legislature left out.

Remarks from Dr. Ken Mash

Mr. Jarin, Governors, Chancellor Cavanaugh, and all,

I speak to you under the most conflicting of circumstances, which are made better only with the slight solace that the System's finances could have been much worse if not for the efforts of our friends in the legislature and members of this body and the hard work actions of our students, my colleagues, and the staff at my organization and those at the State System.

Having personally worked as a student leader to fight against tuition increases at my alma mater, I find it very difficult to stand here today and ask for any tuition increase, let alone a sizeable one (at least by PASSHE standards). This is a sentiment I know is shared by my faculty and coach colleagues across the system.

However, Act 188 makes clear that PASSHE's "shall be to provide high quality education at the lowest possible cost to the students." This Board has worked hard to maintain the latter of those twin goals, and it has succeeded at keeping PASSHE's tuition remarkably low, even as other Universities in the Commonwealth have not followed suit. The Office of the Chancellor has worked hard to look for areas to reduce costs. Our presidents and everyone at our Universities have risen to the challenge, seeking to preserve "high quality" while repeatedly reducing expenditures.

However, in recent years, as enrollment has increased while state funds have decreased, there has been significant cost. Educational opportunities have diminished, co-curricular activities have been evaporating, people who have devoted their lives to serving students have been retrenched, and class sizes continue to grow, often at an alarming rate.

We have reached a point where it would be hard for anyone to say with a straight face that we would be capable of providing the same "high quality" education we have provided to alumni should there not be a rational increase to revenue. Efficiency has reached its pinnacle; the budget axe has simply hit bone.

Our students deserve the same "high quality education" we provided to their fellow citizens. They deserve the same type of education that each member of the Board received when they attended college. We owe it to the Commonwealth's future to deliver the type of education that will allow all of our citizens to blossom. We simply cannot promise our students a Cadillac and deliver them a Yugo.

Nobody revels at the idea of raising the cost of higher education. Nobody. Fortunately, as Chancellor Cavanaugh reported yesterday, grants to eligible students will increase in the upcoming year. You face a tough decision, but our students' futures and the Commonwealth's future depends on the System being able to deliver a "high quality" education to serve its very purpose. The ramifications of a failure to meet our Universities' operational needs are, simply, too stark. We all look to you to make the only rational and responsible decision given the circumstances that have been laid in your collective laps.

This statement is read on behalf of Edinboro Assistant Professor of Theatre, Sharon Taylor, by Lauren Gutshall, Assistant Director of Governmental Relations for APSCUF.

In the fall of 2006, the Edinboro theatre program had three full time faculty, about 12 majors and a handful of minors. Currently, there are two full time faculty, and until this last year about 30 majors and 8 minors. Prior the fall of 2010, when the Dean effectively halted our recruitment efforts, our numbers had been consistently growing.

In the last five year review, completed in May of 2007, the program had completed all of the stated goals of the 2002 Review. The goals of the 2007 review included the completion of an accreditation self study, recruitment of 10-12 majors annually and better visibility and recognition within the community and surrounding schools and theatres.

In the spring of 2008, the program was visited by a NAST (accreditation) consultant. The self study was completed in the summer of 2008. In the fall of 2008, the Dean and Provost decided not to pursue accreditation. (The consultant's feedback suggested that, other than issues of formatting, there was nothing in the self study to preclude accreditation.)

The theatre curriculum was reviewed, revised, and passed by the department in the spring of 2007, and approved by the Dean and the University wide curriculum committee in the spring of 2008. Essentially the new curriculum has been in place for only six semesters. **The remaining two faculty members maintain that the revised curriculum has not been effectively assessed and evaluated.**

One faculty member was diagnosed with cancer in the spring of 2007, was denied tenure in the spring of 2009, resigned in the fall of 2009, and was not replaced. None the less, the theatre faculty members have demonstrated their willingness and conviction that the program can continue to be offered on a two year rotation, with no increased costs and without sacrificing academic integrity or core curriculum obligations.

The theatre program, in addition to being an integral part of the liberal arts nature of the Edinboro campus, contributes importantly to the mission of the University,

In 2009-2010, the theatre program received 650+ (approximately 8.4 of the student body) signed affirmations of value from the campus. The affirmation reads "I believe that the Edinboro Theatre Arts major adds value to the campus and should continue to be offered as a part of the academic curriculum."

Edinboro routinely uses theatre when there is a message of special importance. The University Administration hired a group called **Dramatic Solutions** to present on Improving Workplace Communication. That group also presented at the First Annual Disabilities Conference in August 2010. In September 2010, a session was presented by our faculty at the Annual Diversity Summit on ways in which theatre programs can be used to advance the initiatives of diversity and inclusion. In October, our summer production of **Spoon River Anthology** was a part of the 2ⁿ annual **Literacy In a Multimodal World** Conference at Edinboro.

We have suggested to our Dean and Provost that the theatre program could contribute in an interdisciplinary way throughout the Edinboro campus; at no additional expense, and as added value to the academic and student life of the University and surrounding community. We have suggested courses across the university curriculum that have been regularly offered and taught with multiple sections and empty seats that could be accepted as theatre requirement alternatives, should we find ourselves unable to offer a required course for some reason.

We have had a lot on our plate over the last five years, and faced a lot of difficult situations, never the less, the Theatre program has participated in the American College Theatre Festival, the First Year Experience, and provided support for the President's Scholarship Gala in 2007 and 2010, as well as a collaborative project with the president's office, film program and music program to produce a Batman promotional video. We have hosted workshops on improvisational theatre, acting Shakespeare, fight choreography and dance.

The theatre program receives a tiny budget from the University, as well as a small budget from SGA. We have been told that the University wants us to continue to produce plays. In 2009-2010, the University spent approximately \$300,000 on facility upgrades and improvements, as well as several thousand dollars worth of technology related equipment. The vitality and support we provide to the University, the quality of the educational training and opportunities we provide to our majors and the overall northwestern Pennsylvania area are all reasons to continue the program. Economically and academically, we believe we provide our community with a unique and important opportunity to interact with live theatre.

The English and Theatre Arts department declined to approve placing the program into moratorium, as did the University Wide Curriculum committee and the Faculty Senate. The purpose of this statement is to ask that the Board of Governors refuse to place a vital, dynamic and important program into moratorium, and allow us to continue to grow and contribute to the lives of our students and community.

Thank you.

FYI* if questions

Comparative tuition at other area institutions:

Edinboro 7,400- 8,800

Allegheny College 40,000 year

Gannon University 25,000- 35,000

Mercyhurst no major

Bhrend (Penn state) no major

Slippery Rock 16,300- 22,200

Clarion 14,000-19,500

Executive Summary of Degree Proposal
Master of Science in Integrated Scientific Applications Degree
Millersville University of Pennsylvania

June 29, 2011

1. Appropriateness to Mission

The Master of Science (MS) in Integrated Scientific Applications aligns with the mission and strategic goals of PASSHE and Millersville University of Pennsylvania (Millersville). At the state level, this program will enhance regional economic development efforts by creating and supporting professional and applied programs in emerging science, technology, engineering, and mathematics (STEM) disciplines. It will expand partnerships with business, industry, government, community, and education entities to ensure that students at all levels are better prepared to enter the workforce. In addition, this program will increase student achievement and retention by creating new opportunities for graduate students to be involved in authentic, real-world problems, scholarly research, and public service. Furthermore, students will gain critical technological competencies that are congruent with the workforce needs. At Millersville, this proposal is linked to the university strategic direction of creating academic programs of national distinction that are aligned with and responsive to the state and region's workforce demands of the 21st century.

2. Need

The development of the MS in Integrated Scientific Applications responds to growth in the private sector of the environmental, weather and climate, information, enterprise and the regional and national trends in workforce needs that demand highly skilled scientists and technically astute professionals with good business sense, excellent communication skills, and the ability to work in a team-oriented environment.

The Bureau of Labor Statistics predicts about 48,000 job openings between 2008 and 2018 for environmental scientists requiring a graduate degree. The Congressional Research Service Report for Congress (March, 2008) is one of several national reports that expresses the growing concern that the US is not preparing a sufficient number of practitioners in the STEM areas. Additionally, the market trends indicate the growing, if not urgent, need for a technical workforce prepared beyond the baccalaureate degree with a broader set of skills that will be needed to collaborate across disciplines to tackle complex problems and arrive at holistic solutions.

Reports, such as those produced by the National Research Council and the American Association for the Advancement of Science, point to the national crisis in producing a 21st century, technologically-competent workforce in STEM areas. Notably, earth and environmental system science applications are at the core of

the most pressing problems facing our nation today and across the career timeline of current students.

3. **Academic Integrity**

The MS in Integrated Scientific Applications will comprise 36 credit hours, including interdisciplinary core coursework, study in a specialization, and an internship or applied research activity. The specializations within the program of study include Weather Intelligence and Risk Management, Earth System Informatics, Environmental Systems Management, and Climate Science Applications. The required internship or research activity will be conducted under the mentorship of a faculty member and the supervision of a member of the external partner organization. It is anticipated that students will have opportunities to participate in funded research activities with university faculty or government or private sector scientists and professionals.

4. **Coordination/Cooperation/Partnerships**

The MS in Integrated Scientific Applications demonstrates strong cooperation, drawing broad expertise from multiple academic departments and disciplines at Millersville, including Earth Sciences, Geography, Biology, Chemistry, Computer Science, Economics, Industry and Technology, and Communication as well as Millersville's Center for Environmental Sciences. At the system level, Millersville is an active participant in PASSHE's Professional Science Master's (PSM) Coordinating Committee and will contribute to and benefit from business, organizational management, and other skills courses that are being offered at various partner institutions. These new synergies among institutions focus on educating a workforce that will have the scientific and technical skills embedded in the cross-disciplinary breadth needed to bridge science and business and contribute to innovative approaches that will benefit the marketplace and lead to interesting and productive careers. Finally, Millersville will continue to expand partnerships with business, industry, government, community, and education entities, such as the American Meteorological Society, WeatherBug, and AccuWeather, among many others, to ensure that students at all levels are better prepared to enter the workforce.

5. **Assessment**

Assessment is a continuous process whereby the program students, alumni, and employers provide relevant input regarding program learning outcomes and success. Ongoing program-level assessments will review the effectiveness of program components, allow for the incorporation of any necessary modifications, and document the program's successful elements and longer-term impacts. These elements are not only used to assess the academic program but are also utilized for the program management, recruiting strategies, and evaluation. Student-level assessments will include both embedded course assessments and measurement of student progress at key intervals: program entry, mid-program, and program completion. Alumni will be surveyed on a periodic basis to determine success in placement in relevant career positions and to identify areas where the program should be improved to better prepare students for the workforce. Lastly, the MS in

Integrated Scientific Applications employer advisory board will provide regular input on changing industry needs and assist in identification of internship sites.

6. Resource Sufficiency

Millersville University is recognized as a leader among the 14 PASSHE universities in the sciences and mathematics (PASSHE Fact Book, 2008-09). As an inter-disciplinary and applied graduate degree program, and as a new approach to traditional master's STEM programs, the MS in Integrated Scientific Applications will enhance use of existing resources. Millersville has an extremely well-equipped science complex, including a state-of-the-art Weather Center, and all of the physical resources needed to conduct the program. The College of Graduate and Professional Studies has the staff and expertise to effectively recruit, admit, and support students in the program within existing resources. Faculty in the School of Science and Mathematics, including four meteorologists, possess sufficient expertise to develop and teach the specialized courses envisioned for the program. The five-year budget projection demonstrates program sustainability.

7. Impact on Educational Opportunity

The MS in Integrated Scientific Applications is a highly marketable graduate degree intended to provide a direct and attractive pathway to careers in cutting-edge climate and environmental fields. As the initial program in PASSHE's PSM Initiative, and a STEM graduate degree program at a public university, the MS in Integrated Scientific Applications promotes PASSHE's and Millersville's commitment to access and success. The need has never been greater for a workforce in such cross-disciplinary areas, and this demand will translate into high quality jobs with comparatively high incomes, for all program graduates, and particularly for underrepresented minorities in the STEM fields. The National Governors Association (NGA) Center for Best Practices (2006) asserts that "the current system for producing scientists for business and industry can take eight to nine years beyond the baccalaureate degree and is costly, inefficient, and discourages many bright undergraduate science majors who cannot afford to have, or are simply not interested in, such a protracted delay of their entry into the labor market." The MS in Integrated Scientific Applications addresses these needs, providing students with an opportunity to significantly advance their learning and achieve career advancement in critical-need scientific areas.

Prepared by: Dr. Vilas A. Prabhu, Provost and Vice President for Academic Affairs

Implementation date: Fall 2011

FIVE YEAR BUDGET PROJECTION

UNIVERSITY: Millersville University of Pennsylvania

PROPOSED PROGRAM: Master of Science Degree Program in Integrated Scientific Applications

ESTIMATED REVENUES	Year 1 2011-2012		Year 2 2012-2013		Year 3 2013-2014		Year 4 2014-2015		Year 5 2015-2016	
	Existing	New	Existing	New	Existing	New	Existing	New	Existing	New
Projected University E&G or Tuition		\$46,400		\$107,625		\$135,488		\$190,298		\$209,075
External Grants and Contracts										
Other=Fees		\$3,405		\$15,666		\$33,121		\$49,462		\$61,126
TOTAL REVENUE	\$49,805		\$123,291		\$168,609		\$239,760		\$270,201	
ESTIMATED EXPENSES	Year 1		Year 2		Year 3		Year 4		Year 5	
Salaries and/or benefits (Faculty and Staff)		\$52,149		\$92,113		\$131,155		\$163,855		\$178,277
Learning resources		\$8,500		\$8,500		\$8,500		\$10,500		\$10,500
Instructional Equipment		\$4,000		\$1,500		\$1,500		\$1,500		\$1,500
Facilities and/or modifications		\$1,000		\$1,000		\$1,000		\$1,500		\$1,500
Other		\$16,750		\$14,250		\$15,050		\$13,250		\$13,250
TOTAL EXPENSES	\$82,399		\$117,363		\$157,205		\$190,605		\$205,027	
DIFFERENCE (Rev.-Exp.)	(\$32,594)		\$5,928		\$11,404		\$49,155		\$65,174	
ESTIMATED IMPACT OF NEW PROGRAM	Year 1		Year 2		Year 3		Year 4		Year 5	
Student Headcount FTE Enrollment	5		11.25		13.75		18.75		20	
Projected Annual Credits Generated	120		270		330		450		480	
Tuition Generated	\$46,440		\$107,625		\$135,488		\$190,298		\$209,075	

Executive Summary of Degree Proposal
Master of Science in Strategic Studies in Weapons of Mass Destruction Degree
Indiana University of Pennsylvania

June 29, 2011

1. Appropriateness to Mission

Indiana University of Pennsylvania (IUP) proposes a new Master of Science (MS) in Strategic Studies in Weapons of Mass Destruction degree program. The proposed program closely aligns with the Pennsylvania State System of Higher Education's (PASSHE's) mission, "to be among the nation's leading systems of public universities, recognized for...responsiveness to state, regional, and national needs through quality academic programs, research, and service." The proposed program also aligns with PASSHE's Strategic Initiative related to transforming resources through revenue creation and diversifying revenues to support our mission. Specifically, the proposed MS in Strategic Studies in Weapons of Mass Destruction was developed in response to a specific request by the Federal Bureau of Investigation (FBI) to meet the mission and educational needs of the Weapons of Mass Destruction (WMD) Directorate, and expands IUP's current partnership and contract with the FBI. Therefore, the proposed program exemplifies PASSHE's goals of "implementing best practices in teaching and learning; enhancing institutional flexibility; and increasing financial resources to support our mission." In relation to appropriateness to IUP's mission, IUP prides itself on being "a learning community in touch with the main currents of politics, economical, and cultural life throughout the world." The intellectual value of the proposed graduate program, unique in the nation, will be far-reaching, extending to community, state, and national levels.

2. Need

Protection of America's critical infrastructures, defined by the U.S. Patriot Act as the "systems and assets, whether physical or virtual, so vital to the United States that the incapacity or destruction of such systems and assets would have a debilitating impact on security, national economic security, national public health or safety, or any combination of those matters" is a complex, serious and challenging issue, underscored by the terrorist attacks on September 11, 2001, followed by the subsequent anthrax attacks that began September 18, 2001. Protection of critical assets is essential for the health, life, and high standard of living in the United States. Therefore, the proposed program has been developed in response to a specific request by the FBI for an advanced degree program to provide FBI career agents with the knowledge and skills necessary to identify threats to critical assets; prevent, delay, intervene, and respond to attacks on critical assets; and fulfill the growing need for experts in the field of Strategic Studies in Weapons of Mass Destruction. The proposed program meets the FBI's need for a program that aligns with the mission and educational needs of the Weapons of Mass Destruction (WMD) Directorate.

3. Academic Integrity

The program of study for the MS in Strategic Studies in Weapons of Mass Destruction was developed in collaboration with the FBI, including program design, content,

and delivery methods. Further, the program is based on the Sandia National Laboratories procedural model for protecting national assets, and builds on best-practice principals related to graduate curriculum development and delivery. This process is often referred to as the Critical Asset Vulnerability and Risk Assessment—Performance-Based Evaluation Methodologies (CAVRA-PBEM) model. It provides a procedural framework for the protection of all assets and has a structure which allows performance testing of these procedures. This systems approach to physical security has been refined and tested over the past three decades and has become a government standard. The proposed program's mission supports this framework, which forms the basis for the student learning outcomes. Specifically, the MS in Strategic Studies in Weapons of Mass Destruction is designed to assure that graduates are prepared to:

- Conduct research that adds to the body of knowledge in the area of critical asset protection;
- Apply research and an understanding of asset protection to new and emerging threats;
- Apply knowledge to the understanding of possible motivations behind and contributing factors to political violence and terrorist activities;
- Incorporate new knowledge into the prevention and intervention strategies;
- Apply knowledge to address challenges and issues that emerge in the field of strategic studies in weapons of mass destruction through research, communication, structural design, policy creation, implementation, and evaluation; and
- Work with public and private stakeholders, federal departments and agencies, state and municipal governments, professional organizations, and other people and institutions to protect critical assets by providing and sharing information, promoting awareness, and by creating, implementing, and carrying out the necessary policies, strategies, and projects.

In terms of program quality and comprehensiveness, the proposed program will be comprised of 30 credits, including core requirements, approved electives, and a capstone project. Prospective students will be selected from the population of current FBI WMD Coordinators, Assistant WMD Coordinators, Special Agent Career Path WMD Specialty Agents, and WMD Directorate personnel who fulfill all requirements set by the FBI, and who meet all required graduate admission criteria and program prerequisites as set by IUP. Students will be required to meet all program progression and graduation requirements for conferral of the degree.

4. Coordination/Cooperation/Partnerships

IUP has established strong partnerships with the FBI and Sandia National Laboratories, with five contracts awarded, collectively in excess of \$1.3 million, over the past four years to deliver graduate courses to selected cohorts of FBI agents. These longstanding and successful partnerships and awards have resulted in the proposed innovative master's degree program, with two contract proposals pending for master's cohorts. Moreover, there is a distinct possibility that IUP will be able offer the proposed program under contract to other federal or state agencies.

5. Assessment

To ensure effectiveness and quality of the program, assessment will be conducted at the student and program level. Outcomes assessment of student learning will consist of the analysis of student performance in program core coursework, the capstone class paper and oral presentation, and the research methods course. Each student's success, incorporating the knowledge and techniques acquired in the program into the Synthesis Project, will be evaluated on an ongoing basis by the instructor of record for that class. The final product, comprising a written document and an oral presentation, will be assessed by a designated faculty member.

Program assessment will be part of the Department of Criminology's systematic assessment plan undertaken by the graduate committee. This comprehensive plan will be conducted annually and will include a review of curriculum, program satisfaction, resources, and College, University, and PASSHE alignment. Program assessment methods will include exit interviews with program completers, surveys of alumni, and feedback from field practitioners. Results will be reviewed annually and used to refine the program. Program assessment will be shared with the FBI on an ongoing basis to assure program quality and effectiveness. Program assessment will occur for progress and compliance as per contractual relationship with the FBI as well as the University's ongoing assessment process to include the Board of Governors five-year program review.

6. Resource Sufficiency

IUP will implement the MS in Strategic Studies in Weapons of Mass Destruction when the contract with the FBI is executed and funded. The program is designed on a cohort model of 20–25 students, selected by the FBI and admitted by IUP. With a cohort model of competitively screened and selected graduate students, student retention and completion is projected to be 80%. The external contract will fully fund the proposed graduate program ensuring resource sufficiency. Specifically, grant revenues will cover all costs of instruction (tuition and fees) at a contracted rate, faculty professional development, learning resources, and travel, with overhead. With sufficient instructional spaces and instructional materials, no new internal resources are required to implement the proposed program.

7. Impact on Educational Opportunity

The FBI is committed to diversity in employment, and as such, this commitment will translate into a diverse student population in the program. The FBI Director, Robert S. Mueller II, recently said, "Second, we want more diversity in the FBI. The fact is, we need it and place the highest value on it. Why? Because it is absolutely vital to getting the job done for our country." Both IUP and the FBI will benefit from this commitment to diversity in program enrollees and graduates.

Prepared by: Dr. Gerald Intemann, Provost and Vice President for Academic Affairs

Implementation date: Fall 2011

FIVE-YEAR BUDGET PROJECTION

UNIVERSITY: Indiana University of Pennsylvania

PROPOSED PROGRAM: Master of Science Degree Program in Strategic Studies in Weapons of Mass Destruction

ESTIMATED REVENUES	Year 1 2011-12		Year 2 2012-13		Year 3 2013-14		Year 4 2014-15		Year 5 2015-16	
	Existing	New	Existing	New	Existing	New	Existing	New	Existing	New
Tuition*										
External Grants and Contracts*		\$283,896		\$292,413		\$301,196		\$310,249		\$319,553
Other = Fees										
TOTAL REVENUE	\$283,896		\$292,413		\$301,196		\$310,249		\$319,553	
EST EXPENSES	Year 1		Year 2		Year 3		Year 4		Year 5	
	Existing	New	Existing	New	Existing	New	Existing	New	Existing	New
Salaries &/or benefits (Faculty/Staff)	\$105,840		\$109,015		\$112,291		\$115,658		\$119,137	
Learning resources	\$49,000		\$50,470		\$51,984		\$53,544		\$55,150	
Instructional equipment										
Facilities and/or modifications										
Other (Travel)	\$7,000		\$7,210		\$7,426		\$7,649		\$7,878	
TOTAL EXPENSES	\$161,840		\$166,695		\$171,701		\$176,851		\$182,165	
DIFFERENCE Rev.-Exp.	\$122,056		\$125,718		\$129,495		\$133,398		\$137,388	
ESTIMATED IMPACT OF NEW PROGRAM	Year 1		Year 2		Year 3		Year 4		Year 5	
	Existing	New	Existing	New	Existing	New	Existing	New	Existing	New
FTE Enrollment	15		12		20		16		20	
Projected Annual Credits Generated	270		216		360		288		360	
Tuition Generated										

Budget Notes: *External grant/contract revenues will cover costs of instruction (tuition) at a contracted rate, faculty professional development, learning resources, and travel.

**Executive Summary of Degree Proposal
Bachelor of Arts in Jurisprudence Degree
California University of Pennsylvania**

June 29, 2011

1. Appropriateness to Mission

The Pennsylvania State System of Higher Education Strategic Initiatives are grounded in the System's mission to be among the nation's leading systems of public universities, recognized for (1) access and affordability of excellent undergraduate and graduate education, and (2) responsiveness to state, regional, and national needs through quality academic programs, research, and service. This program is in alignment with the university's *2010-2015 Strategic Plan: Objective 1.1: Create, implement and evaluate a comprehensive Academic Plan to advance University-wide academic excellence* and reaffirms their dedication to character education. The BA in Jurisprudence will be a central force and player in that formation at: *Goal Eight: To foster civic engagement, that is, a commitment to accept and perform the duties and obligations of belonging to a community, a Commonwealth, a Nation, and the World.*

2. Need

In both the historic and evolving legal fields of law and jurisprudence, national demand continues unabated. While many occupations are tracked and assessed that directly correlate to the field of jurisprudence, not all fit as neatly. Aside from lawyers and judges, where growth is undeniable, the opportunities are multifaceted. Rising demand for title examiners, administrative judicial personnel, not-for profit advocacy groups, think-tank researchers, insurance analysts, securities enforcement, commodities regulators, inspectors and disability evaluators all bode well for jurisprudence graduates.

3. Academic Integrity

The program will be housed in the School of Science and Technology, Department of Professional Studies, where it will be part of a larger delivery system emanating from Law and Public Policy and Legal Studies. The learning objectives of the program are to:

- Identify schools of jurisprudence;
- Compare and contrast the various schools of jurisprudence in terms of legal decision or legal result;
- Prepare high level research products in law and jurisprudence;
- Contrast human law with more transcendent versions and definitions of law;
- Summarize and critique the various jurisprudential theories;
- Compile sophisticated research findings involving law and jurisprudence;
- Justify the defense or advocacy of a particular legal issue or problem;
- Propose diverse ways in which a legal problem can be resolved;
- Integrate moral and ethical reasoning into legal applications; and
- Respond to traditional criticisms of Anglo-American/Western Jurisprudence.

The curriculum will stress the foundational periods of jurisprudence from the ancient and medieval period to the founding period of the American experience. It will also delve into contemporary viewpoints on jurisprudence.

The BA in Jurisprudence rests upon central goals. First, graduates of the program will discern how law plays out in democratic processes. Second, the BA in Jurisprudence delivers a unique program of instruction and model for integration of knowledge and character. Few periods in the history of our republic manifest the intense need for leaders and graduates who understand the importance of character and personal integrity coupled with professional competence. Third, and from a functional perspective, few majors will afford the accomplished student with the deep level of conceptual coverage and analysis as will the BA in Jurisprudence. The degree is a demanding undertaking that will likely attract the best and brightest students, including new freshmen matriculating directly from high school and transfer students from community colleges and other institutions. The level of comprehension necessary to read classical and medieval materials in jurisprudence as well as the diverse jurisprudential schools, in conjunction with related subject matter involving character, conscience, virtue and the ends and aims of jurisprudence itself, will test even the finest student. Skill at exposition, oratory, and interpretation will have to be at the highest level. Fourth, the BA in Jurisprudence hopes to form and habituate future leaders who will lead with virtue and ethics.

4. Coordination/Cooperation/Partnerships

The program will also seek strong alliances with the Departments of Philosophy, History and Political Science; all have capable faculty and complimentary course offerings. Students will be provided ample opportunity to study jurisprudence through these unique perspectives which elaborate jurisprudential principles. Students are required to take at least 12 credits of electives, such as: POS 228: Classical Political Thought; POS 314: Constitutional Law: Government Power; POS 306: The Congress; POS 330: American Political Ideas; PHL 201: Ancient Philosophy; PHL 220: Ethics; PHL 320: Ethical Theory; HIS 331: Ancient Greece; HIS 341: Early Middle Ages and HIS 342: High and Late Middle Ages.

The BA in Jurisprudence will be residually based on the main campus of Cal U. However, the program will continuously stress opportunities for unique, independent study experiences, such as high level research under faculty guidance, a senior thesis requirement, foreign study in programs such as Cal U-Cambridge, participation in the University Honors Program, and active contributions to the Institute of Law and Public Policy. While primarily a lecture-based pedagogy, the program has expectations for student excellence in legal exposition and rhetoric.

5. Assessment

Both the institution and faculty members are expected to measure and assess student outcomes. Annual surveys, alumni surveys, graduation and retention rates, and level of post-baccalaureate education, in either traditional graduate programs or law school will be conducted. Faculty will monitor the results of

course evaluations, and in consultation with the chair, seek out methods of teaching excellence. The department will conduct its own student surveys, administer a pre-test to its applicants in the first jurisprudence course and a post-test upon completion of the senior thesis, as well as calculate and compute average GPA and other measures of academic performance such as AP subject matter testing for credit equivalency. Assessment data will be collected annually and reported to the administration in the program's annual report. The program will follow the five-year program review cycle. Program faculty will meet annually to review assessment data and take action as appropriate. Aside from the program's regular assessment of exams, research and paper designs, and advocacy of legal argument, each student will be required to author a major work in the form of a senior thesis. The thesis, authored under the tutelage of a full time faculty member, will be the capstone experience.

6. Resource Sufficiency

Resources for the program will call for two new full-time faculty hires and an investment in more library materials relevant to the subject matter. In addition, to assure the statewide and national audience such a program demands, sufficient funding for recruitment of potential majors is sought each year of the program's initial five-year life.

7. Impact on Educational Opportunity

The implementation of the BA in Jurisprudence program will inexorably and positively alter the culture of the university and the surrounding environs. With its emphasis on the nature of rights, justice and democratic ideals, underrepresented groups will greatly benefit from this program. In assessing the university's protocol and vision for diversity, relevant to the BA in Jurisprudence is: *Objective 3.3: Promote a culture of civility, tolerance and inclusiveness*. Western jurisprudence finds its inherent stability in these values, notions that our world sees character rather than color, the moral agent preferred over the arbitrary actor, and the critical thinker on major legal and ethical dilemmas preferred over the tyrannical actor. Jurisprudence can only promote these core values.

Prepared by: Geraldine M. Jones, Provost and Vice President for Academic Affairs

Implementation date: Fall 2012

FIVE YEAR BUDGET PROJECTION

UNIVERSITY: California University of Pennsylvania

PROPOSED PROGRAM: Bachelor of Arts Degree in Jurisprudence

ESTIMATED REVENUES	Year 1 2011-2012		Year 2 2012-2013		Year 3 2013-2014		Year 4 2014-2015		Year 5 2015-2016	
	Existing	New	Existing	New	Existing	New	Existing	New	Existing	New
Projected University E&G or Tuition		\$290,400		\$522,720		\$813,120		\$929,280		\$1,161,600
External Grants and Contracts				\$2,000		\$4,000		\$6,000		\$8,000
Other=Fees										
TOTAL REVENUE	\$290,400		\$524,720		\$817,120		\$935,280		\$1,169,600	
ESTIMATED EXPENSES	Year 1		Year 2		Year 3		Year 4		Year 5	
Salaries and/or benefits (Faculty and Staff)	\$150,000	\$8,000	\$236,900	\$80,000	\$326,407		\$336,199	\$80,000	\$428,685	
Learning resources	\$20,000	\$65,000		\$20,000		\$20,000		\$20,000		\$20,000
Instructional Equipment		\$1,000		\$15,000		\$20,000		\$20,000		\$25,000
Facilities and/or modifications										
Other		\$8,000		\$60,000		\$80,000		\$60,000		\$60,000
TOTAL EXPENSES	\$252,000		\$411,900		\$446,407		\$516,199		\$533,865	
DIFFERENCE (Rev. - Exp.)	\$38,400		\$112,820		\$370,713		\$419,081		\$635,735	
ESTIMATED IMPACT OF NEW PROGRAM	Year 1		Year 2		Year 3		Year 4		Year 5	
Student Headcount FTE Enrollment	50		90		140		160		200	
Projected Annual Credits Generated	1500		2700		4200		4800		6000	
Tuition Generated	\$290,400		\$522,720		\$813,120		\$929,280		\$1,161,600	

**Exceptions to the 120-Credit Requirement
in Board of Governors' Policy 1990-06A**
(May 25, 2011)

Selected System-wide baccalaureate degree programs will be granted an exception to the 120-credit maximum requirement because of extensive regulatory and accreditation requirements currently in place.

Education

The following programs will be permitted graduation credit totals not to exceed 123 credits through summer 2013, at which time the exceptions will be reviewed:

- Communications (7-12)
- Cooperative Education (7-12)
- Environmental Education (PreK-12)
- Family-Consumer Science (PreK-12)
- Health (PreK-12)
- Hearing Impaired (PreK-12)
- Language (PreK-12)
 - English
 - French
 - German
 - Latin
 - Russian
 - Spanish
- Library Science (PreK-12)
- Social Sciences (7-12)
- Social Studies (7-12)
- Upper Elementary/Middle Level (Grades 4-8) Education

The following programs will be permitted graduation credit totals not to exceed 129 credits through summer 2013, at which time the exceptions will be reviewed:

- Art (PreK-12)
- Business-Computer-Information Technology (PreK-12)
- Citizenship (7-12)
- Health and Physical Education (Pre-K-12)
- Mathematics (7-12)
- Music (PreK-12)

- Science (7-12)
 - Biology
 - Chemistry
 - Earth and Space
 - General Science
 - Physics
- Technology Education (PreK-12)

The following programs will be permitted graduation credit totals not to exceed 135 credits through summer 2013, at which time the exceptions will be reviewed:

- Special Education/PreK-4 Dual Certification
- Special Education/Upper Elementary/Middle Level (4-8) Dual Certification

Other

The following programs will be permitted graduation credit totals not to exceed 123 credits through summer 2013, at which time the exceptions will be reviewed:

- Music
- Music Performance
- Music Therapy
- Music w/ Elective Studies in Business

Due to specific accreditation requirements, the following programs will be permitted graduation credit totals not to exceed 124 credits through spring 2013, at which time the exceptions will be reviewed:

Bloomsburg

- B.S. Electrical and Electronics Engineering Technology

California

- B.S. Electrical Engineering Technology
- B.S. Computer Engineering Technology

The following programs will be permitted graduation credit totals not to exceed 126 credits through summer 2013, at which time the exceptions will be reviewed:

- Respiratory Therapy

Pennsylvania State System of Higher Education Internal Audit and Risk Assessment Budget

Revenue/Sources	FY 2010/11	FY 2011/12	Change	%
Appropriations	\$880,452	\$830,296	(\$50,156)	-5.7%
Use of Carryforward Fund Balance	-	57,868	57,868	n/a
Total Revenue/Sources	\$880,452	\$888,164	\$7,712	0.9%
Expenditures and Transfers				
Compensation Summary**				
Salaries & Wages	\$527,583	\$516,579	(\$11,004)	-2.1%
Benefits	216,952	211,856	(5,096)	-2.3%
Subtotal, Compensation	\$744,535	\$728,435	(\$16,100)	-2.2%
Services and Supplies	135,917	159,729	23,812	17.5%
Total Expenditures and Transfer	\$880,452	\$888,164	\$7,712	0.9%
Revenue/Sources Less Expenditures/Transfers				
	\$0	\$0	\$0	0.0%

FTE Employees	FY 2010/11	FY 2011/12	Change	%
AFSCME	1.00	1.00	0.00	0%
Nonrepresented	6.00	6.00	0.00	0%
Total Employees	7.00	7.00	0.00	0%



PENNSYLVANIA STATE SYSTEM OF HIGHER EDUCATION OFFICE OF INTERNAL AUDIT and RISK ASSESSMENT 2011-12 ANNUAL WORK PLAN

Work Plan Process Development

The OIARA 2011-12 work plan contains ongoing carryover projects from the prior year, newly identified project initiatives, university risk assessments, and special project requests. The plan was developed to meet the internal audit needs of each university and the Office of the Chancellor.

Carryover 2010-11 Annual Work Plan Assignments - Ongoing

The prior year's work plan, approved at the July 2010 Board of Governors' meeting, covered the period spanning fiscal year 2010-11. The OIARA is presently completing work on twelve assignments (audits, risk assessment, and special projects) that are carrying forward for completion during fiscal year 2011-12.

New 2011-12 Work Plan Initiatives

Audit projects contained within the Department's proposed 2011-12 work plan support PASSHE's strategic planning and include completion of university-based risk assessments, National Collegiate Athletic Association (NCAA) Agreed Upon Procedure reviews, internal audit projects intended to assess internal controls, operational processes and compliance with existing policies and guidelines.

Completion of the NCAA Agreed Upon Procedures by the OIARA will provide an estimated \$130,000 overall cost savings this fiscal year by not outsourcing this required review for Division II institutions to an external public accounting firm.

University Proposed Audit Projects

University-based projects, contained within the 2011-12 fiscal year work plan, include the following:

- Affiliated Entities
- University Book Store
- Enrollment Management
- IT General Controls Review
- Presidential Transition
- Purchasing Cycle
- Cash Collection
- Fixed Assets
- National Collegiate Athletic Association – Agreed Upon Procedures Attestation

System Office Proposed Project

Within the Office of the Chancellor, the OIARA will complete a review of the performance funding model, verifying distribution of Board of Governors approved performance funding monies based upon program guidelines.

System-wide Proposed Project

From a System-wide perspective, the OIARA will perform an analysis of Dual Compensation payments to PASSHE employees, ensuring consistency in payment calculations, administration and application.

University Risk Assessment Exercise

University risk assessments, with an overarching goal affording for prioritized internal audit planning based on recognized levels of risk exposure and impact of potential liabilities, will be conducted at four selected universities during the plan year.

Special Projects

Board of Governors Policy 1991-09-A, *State System Audit Policy*, provides for the Office of Internal Audit and Risk Assessment to conduct special project audits and investigations as requested by the Board of Governors, the Chancellor and University Presidents, as well as outside entities, e.g., the Commonwealth's Auditor General or Inspector General. Projects of this nature will be considered as presented throughout the course of fiscal year 2011-12.



Office of Internal Audit and Risk Assessment

2011-2012 Work Plan

University	Carryover Project(s)	Project #1	Project #2	Project #3
Bloomsburg	Sarbanes Oxley Best Practices	Risk Assessment	NCAA	
California	(1) Risk Assessment (2) Accounts Payable	Affiliated Entities	NCAA	
Cheyney		Campus Book Store	Purchasing Cycle	
Clarion	International Study Abroad	Risk Assessment	Affiliated Entities	
East Stroudsburg		NCAA	Presidential Transition	
Edinboro	Presidential Transition	Affiliated Entities	NCAA	
Indiana	Sarbanes Oxley Best Practices	Affiliated Entities	NCAA	
Kutztown		Enrollment Management	NCAA	Affiliated Entities
Lock Haven	(1) Presidential Transition (2) Student Data Base Access	Affiliated Entities	NCAA	
Mansfield		IT General Review	Affiliated Entities	
Millersville	Sarbanes Oxley Best Practices	Risk Assessment	NCAA	
Shippensburg		Affiliated Entities	Cash Collection	
Slippery Rock	Art Department	Presidential Transition	NCAA	
West Chester	(1) Employee/Vendor Analysis (2) Financial Aid Packaging	Risk Assessment	NCAA	Fixed Assets
Office of the Chancellor		Performance Funding	Dual Compensation	

* Special Project Requests (as proposed) and follow-up review of prior year's audit findings will also be completed.

**Pennsylvania State System of Higher Education
Fiscal Year 2011/12 Tuition Schedule**

Student Classification	2010/11	2011/12	Change
Full-Time Academic Year			
Resident Undergraduate	\$5,804		
Nonresident Undergraduate:			
150% (Minimum) (CL*, EA*, ED, SH*, SL*, MSC*)	\$8,706		
160% (CA)	\$9,288		
165% (MA*)	\$9,578		
200% (CH*, CL*, SL*)	\$11,608		
\$2,000 less than 250% rate (LO)	\$12,510		
225% (SH*)	\$13,060		
250% (BL, CA*, CH*, CL*, EA*, IN*, KU, LO*, MA* MI, SH*, WE)	\$14,510		
Full-Time Semester			
Resident Undergraduate	\$2,902		
Nonresident Undergraduate:			
150% (Minimum) (CL*, EA*, ED, SH*, SL*, MSC*)	\$4,353		
160% (CA)	\$4,644		
165% (MA*)	\$4,789		
200% (CH*, CL*, SL*)	\$5,804		
\$2,000 less than 250% rate (LO)	\$6,255		
225% (SH*)	\$6,530		
250% (BL, CA*, CH*, CL*, EA*, IN*, KU, LO*, MA* MI, SH*, WE)	\$7,255		
Per Student Credit Hour**			
Resident Undergraduate	\$242		
Resident Graduate	\$387		
Nonresident Undergraduate:			
150% (Minimum) (CL*, EA*, ED, SH*, SL*, MSC*)	\$363		
160% (CA)	\$387		
165% (MA*)	\$399		
200% (CH*, CL*, SL*)	\$484		
\$2,000 less than 250% rate (LO)	\$521		
225% (SH*)	\$544		
250% (BL, CA*, CH*, CL*, EA*, IN*, KU, LO*, MA* MI, SH*, WE)	\$605		
Nonresident Graduate	\$619		
Nonresident Undergraduate Distance Education, Minimum	\$247		
Nonresident Undergraduate Distance Education, Maximum	\$605		
Nonresident Graduate Distance Education, Minimum	\$395		
Nonresident Graduate Distance Education, Maximum	\$968		

Note: Final 2011/12 tuition recommendations will be developed at the Board of Governors' Finance, Administration, and Facilities Committee meeting on June 29, 2011.

Note: In limited circumstances, Universities may charge different rates based upon geographic location, academic programs, and modality of education.

*Applies to certain nonresident students, based upon geographic location, academic program, or academic standing.

**For graduate student charges, part-time, summer and interim session student charges.

**Pennsylvania State System of Higher Education
Fiscal Year 2011/12 Technology Tuition Fee Schedule**

Student Classification	2010/11	2011/12	Change
Full-Time Academic Year		<i>Note: Final 2011/12 technology tuition fee recommendations will be developed at the Board of Governors' Finance, Administration, and Facilities Committee meeting on June 29, 2011.</i>	
Resident Undergraduate	\$232		
Nonresident Undergraduate	\$350		
Full-Time Semester			
Resident Undergraduate	\$116		
Nonresident Undergraduate	\$175		
Per Credit (part-time and graduate students)			
Resident Undergraduate (less than 12 credits)	N/A		
Nonresident Undergraduate (less than 12 credits)	N/A		
Resident Graduate (less than 9 credits)	N/A		
Nonresident Graduate (less than 9 credits)	N/A		
Part-Time (Flat rate for all part-time students)*		Discontinued in 2011/12	
Resident Undergraduate (less than 12 credits)	\$68		
Nonresident Undergraduate (less than 12 credits)	\$93		
Resident Graduate (less than 9 credits)	\$68		
Nonresident Graduate (less than 9 credits)	\$93		

**For part-time student charges, and summer and interim sessions.*

**Pennsylvania State System of Higher Education
Funding of System-Wide Initiatives from the Fiscal Year 2011/12 E&G Appropriation**

Performance Funding\$35,851,000

Since fiscal year 2005/06, PASSHE's performance funding program has been funded through a combination of the E&G appropriation and the Program Initiatives line item appropriation. The fiscal year 2011/12 Commonwealth budget eliminated PASSHE's line item appropriations, requiring all performance funding to be allocated from the E&G Appropriation. Consistent with the performance funding program revisions adopted by the Board of Governors at its January 2011 meeting, the performance funding pool is established at 2.4% of the System's estimated 2011/12 E&G budget, which is established after the approval of 2011/12 tuition rates by the Board of Governors.

Dixon University Center Academic Program\$1,148,000

The academic programming performed at Dixon University Center has been funded through the E&G appropriation at \$1.4 million since fiscal year 2005/06. The total appropriation recommended for continuation of these academic services and associated maintenance of the Dixon University Center site is \$1,148,000. This represents an 18% reduction in funding for these activities from the previous year.

Office of Internal Audit and Risk Assessment\$830,296

This office is responsible for facilitating risk assessment activities and, in turn, structuring and executing an internal audit plan based on high risk areas. The office's fiscal year 2011/12 budget of \$888,164 is recommended for approval in today's Audit Committee materials. It is recommended that the Office of Internal Audit and Risk Assessment's budget be funded at \$830,296 as it has \$57,868 remaining from the previous year's allocation.

Replenishment of the System Reserve\$562,815

The total recommended allocation to the System Reserve for fiscal year 2011/12 is \$562,815, which will replenish the System Reserve to the \$1,500,000 level required by Board of Governors' Policy 1984-07-A, *System Reserve Allocation and Expenditure Criteria*. Attachment 2 is a detailed list of expenditures for fiscal year 2010/11 and a list of projected expenditures for fiscal year 2011/12. The amount to be replenished is less than the total expenditures, due to interest earnings.

McKeever Environmental Learning Center\$302,032

The Commonwealth created the McKeever Environmental Learning Center in 1974 to assist citizens of all ages in becoming better stewards of the earth's resources. The environmental education programs offered by the McKeever Center meet the needs of students from preschool through, and beyond, college and provide student interns with valuable teaching experience while working in an outdoor setting. The McKeever Center is administered by Slippery Rock University of Pennsylvania and has been funded through a combination of direct line item appropriation, a portion of PASSHE's E&G appropriation, and user fees. An allocation of \$313,082 is recommended for operation of the McKeever Environmental Learning Center. This represents an 18% reduction in funding from the E&G appropriation for these activities from the previous year, in addition to the elimination of the Center's line item funding in the proposed Commonwealth budget.

**Pennsylvania State System of Higher Education
Report of Expenditures from the System Reserve**

Actual 2010/11 Expenditures

Kutztown Property Appraisal	\$2,250
CFRED (East Stroudsburg) Property Appraisal	3,450
Presidential Searches (Clarion and Lock Haven)	42,776
System Financial Audit (Fiscal Year 2009/10)	80,430
Official Residence (Edinboro)	<u>514,332</u>

Total Actual Fiscal Year 2010/11 Expenditures	\$643,238
--	------------------

Anticipated 2011/12 Expenditures

Presidential Searches (East Stroudsburg, Edinboro, Indiana, and Slippery Rock)	\$168,000
System Financial Audit (Fiscal Year 2010/11)	<u>82,183</u>

Total Anticipated Fiscal Year 2011/12 Expenditures	\$250,183
---	------------------

Capital Spending Plan
Fiscal Years 2011/12 Through 2015/16
As Presented to the Board of Governors
June 29, 2011

Financial Summary in Current Year Dollars (\$000)						
University	FY 2011/12	FY 2012/13	FY 2013/14	FY 2014/15	FY 2015/16	Five-Year Total
Bloomsburg	\$24,102	\$2,100		\$14,626		\$40,828
California	9,700	6,400	\$970		\$16,000	33,070
Cheyney	3,000	500	8,000		33,000	44,500
Clarion	8,000		34,900		5,400	48,300
East Stroudsburg		39,800		27,800	2,500	70,100
Edinboro	3,400	3,320	17,847		1,500	26,067
Indiana	15,900	31,100	23,410	7,000	23,017	100,427
Indiana*			23,410			23,410
Kutztown	17,041		1,700	15,407	17,800	51,948
Lock Haven	4,500	5,290		8,600	8,875	27,265
Mansfield	7,800	20,000	500	1,000		29,300
Millersville	12,200	1,600		10,400		24,200
Shippensburg		9,147		14,175	6,100	29,422
Slippery Rock	5,700	4,600	11,700	13,100	1,100	36,200
West Chester	22,084	4,000		8,100		34,184
Five-Year Total	\$133,427	\$127,857	\$122,437	\$120,208	\$115,292	\$619,221

Financial Summary in Future Year Dollars (\$000) Allowing for Inflation at 3% Annually						
University	FY 2011/12	FY 2012/13	FY 2013/14	FY 2014/15	FY 2015/16	Five-Year Total
Bloomsburg	\$24,102	\$2,200		\$16,000		\$42,302
California	9,700	6,600	\$1,000		\$18,000	35,300
Cheyney	3,000	500	8,500		37,100	49,100
Clarion	8,000		37,000		6,100	51,100
East Stroudsburg		41,000		30,400	2,800	74,200
Edinboro	3,400	3,420	18,900		1,700	27,420
Indiana	15,900	32,000	24,850	7,600	25,900	106,250
Indiana*			24,850			24,850
Kutztown	17,041		1,800	16,900	20,000	55,741
Lock Haven	4,500	5,420		9,400	9,900	29,220
Mansfield	7,800	20,600	500	1,100		30,000
Millersville	12,200	1,600		11,400		25,200
Shippensburg		9,400		15,500	6,900	31,800
Slippery Rock	5,700	4,700	12,400	14,300	1,200	38,300
West Chester	22,084	4,100		8,900		35,084
Five-Year Total	\$133,427	\$131,540	\$129,800	\$131,500	\$129,600	\$655,867

*Subject to fund-raising progress.

**FY 2011/12 Through FY 2015/16 Project Execution Schedule
As Presented to the Board of Governors
June 29, 2011**

Proposed Execution Year	University	Project Description	Original Furniture and Equipment (OF&E)?	Authorization Act	Total Authorization (\$000)	Facility Use	University Funds (\$000)	Commonwealth Funding Adjusted for Inflation at 3%/Year (\$000)
2011/12	Bloomsburg	Waller Administration Building Renovation		40/04, 41/08, 82/10	27,500	Mixed Usage		\$24,102
	California	Coover Hall Renovation		82/10	14,500	Science and Technology		9,700
	Cheyney	New Student Housing Construction (Additional Funds)		83/06, 41/08, 82/10	2,500	Housing		2,500
			OF&E	83/06, 41/08, 82/10	2,200	Housing		500
	Clarion	Tippin Gymnasium Renovation and Expansion (Design)		41/08, 82/10	8,000	Athletics		8,000
	Edinboro	Ross Hall Renovation/Replacement Construction (Additional Funds)		41/08	3,800	IT Backbone		2,000
		Ross Hall Renovation/Replacement	OF&E	82/10	1,500	IT Backbone		1,400
	Indiana	Weyandt/Walsh Hall Renovation or Replacement (Design)		82/10	90,000	Science and Technology		15,900
	Kutztown	Educational Building (Lytle Hall) Demolition and Replacement/Expansion		41/08	30,000	General Education		17,041
	Lock Haven	Science and Math Center Renovation and Construction, East Campus	OF&E	83/06, 82/10	3,000	Science and Technology		3,000
		Science and Math Center Renovation and Construction, East Campus (Additional Funds)		83/06, 82/10	12,000	Science and Technology		1,500
	Mansfield	Straughn Auditorium Renovation		82/10	6,000	Performing Arts		5,100
		Water Treatment Plant Upgrade (Additional Funds)		41/08	2,700	Utilities Infrastructure		2,700
	Millersville	Electrical Utilities Upgrade (Additional Funds)		131/02, 82/10	10,570	Utilities Infrastructure	1,328	10,200
		Ganser Library Renovation (Additional Funds)		131/02, 82/10	7,586	Libraries		2,000
	Slippery Rock	Central Boiler Plant Renovation, Phase 3 (Additional Funds)		82/10	4,000	Utilities Infrastructure		1,200
		Miller Auditorium Renovation and Addition (Additional Funds)		83/06	5,000	Performing Arts		4,500
	West Chester	Campus Geothermal Utility Conversion, Phase 2		82/10	17,000	Utilities Infrastructure		15,100
		Academic Classroom and Office Complex Construction (Additional Funds)		40/04	24,984	Business Education		6,984
	2011/12 Total							
2012/13	Bloomsburg	Waller Administration Building Renovation	OF&E	82/10	2,200	Mixed Usage		\$2,200
	California	Pedestrian and Vehicular Enhancements, Phase I		131/02, 41/08, 82/10	7,592	Utilities Infrastructure		6,600
	Cheyney	Browne Hall Renovation	OF&E	83/06	500	Housing		500
	East Stroudsburg	Information Commons Construction, Phase I	OF&E	82/10	3,600	Mixed Usage		2,900
		Information Commons Construction, Phase 1 (Construction)		82/10	36,000	Mixed Usage	30,000	29,900
		Information Commons Construction, Phase 2 (Design)		82/10	40,000	Mixed Usage		8,200
	Edinboro	Mold Tooling/Mold Design Classrooms Construction		40/04	3,420	Science and Technology		3,420
	Indiana	Keith and Leonard Halls Renovation (Construction)		83/06, 131/02, 41/08, 82/10	32,065	General Education		28,600
		Keith and Leonard Halls Renovation	OF&E	131/02, 82/10	5,917	General Education		3,400
	Lock Haven	E&G Structures Demolition		40/04	1,620	Administration		1,620
		Fiber-Optic Infrastructure Upgrade		131/02, 82/10	4,720	IT Backbone		3,800
	Mansfield	New Student Housing Construction		82/10	25,000	Auxiliary		20,600
	Millersville	Ganser Library Renovation	OF&E	131/02, 82/10	1,600	Libraries	2,000	1,600
	Shippensburg	Electrical Distribution System Renovation		40/04	8,730	Utilities Infrastructure		5,800
		Telecommunications Distribution System Renovation		82/10	4,000	IT Backbone		3,600
	Slippery Rock	Miller Auditorium Renovation and Addition	OF&E	83/06	3,000	Performing Arts		1,000
		Deferred Maintenance Projects 1		82/10	8,000	Infrastructure		1,000
		West Gym Dance Modifications		82/10	5,000	Performing Arts		2,700
	West Chester	Mitchell Hall Renovation	OF&E	82/10	1,500	Arts and Music		1,200
		Academic Classroom and Office Complex Construction	OF&E	131/02, 82/10	3,522	Business Education		2,900
2012/13 Total								\$131,540

Proposed Execution Year	University	Project Description	Original Furniture and Equipment (OF&E)?	Authorization Act	Total Authorization (\$000)	Facility Use	University Funds (\$000)	Commonwealth Funding Adjusted for Inflation at 3%/Year (\$000)
2013/14	California	Coover Hall Renovation	OF&E	131/02	677	Science and Technology		\$1,000
	Cheyney	Cope Hall Renovation/Addition (Design)		82/10	8,500	Athletics		8,500
	Clarion	Tippin Gymnasium Renovation and Expansion	OF&E	131/02, 82/100	3,095	Athletics		3,100
		Tippin Gymnasium Renovation and Expansion (Construction)		41/08, 82/10	34,500	Athletics		33,900
	Edinboro	Maintenance Building Replacement		83/06, 41/08, 82/10	20,600	Administration		15,400
		Mold Tooling/Mold Design Classrooms Construction	OF&E	131/02	292	General Education		300
		Deferred Maintenance		82/10	8,000	Utilities Infrastructure		3,200
	Indiana	Weyandt/Walsh Hall Renovation or Replacement, Phase 1 (Construction)		82/10	90,000	Science and Technology		24,850
		Weyandt/Walsh Hall Renovation or Replacement, Phase 1 (Construction; Pending Fund Raising)		82/10	90,000	Science and Technology		24,850
	Kutztown	Educational Building (Lytle Hall) Demolition and Replacement/Expansion	OF&E	131/02	50	General Education		1,800
	Mansfield	Straughn Auditorium Renovation	OF&E	82/10	1,000	Performing Arts		500
	Slippery Rock	McKay Building Renovation/Addition		22/00, 82/10	13,360	General Education		12,400
2013/14 Total								\$129,800
2014/15	Bloomsburg	McCormick Center Renovation		82/10	19,000	General Education		\$16,000
	East Stroudsburg	Information Commons Construction, Phase 2 (Construction)		82/10	40,000	Mixed Usage		30,400
	Indiana	Weyandt/Walsh Hall Renovation or Replacement	OF&E	82/100	9,000	Science and Technology		7,600
	Kutztown	Poplar House Renovation/Addition		82/10	5,000	Administration		4,100
		DeFrancesco Education Building Renovation		82/10	13,000	Business Education		12,800
	Lock Haven	South Ulmer Hall Renovation		131/02	8,566	General Education		9,400
	Mansfield	New Student Housing Construction	OF&E			Auxiliary		1,100
	Millersville	Stayer (Jefferson Hall) Building Renovation		41/08, 82/10	13,000	Athletics		11,400
	Shippensburg	Franklin Science Center Renovation		82/100	15,000	Science and Technology		15,500
	Slippery Rock	Student Success Center Renovation		82/10	15,000	Administration		14,300
	West Chester	Sturzebecker Health Science Center Renovation/Addition		131/02	8,900	Science and Technology		8,900
2014/15 Total								\$131,500
2015/16	California	Old Main and South Hall Renovation		131/02, 83/06	22,300	Mixed Usage		\$18,000
	Cheyney	Cope Hall Renovation/Addition (Construction)		82/10	36,500	Athletics		37,100
	Clarion	Marwick Boyd Fine Arts Addition/Renovation (Design)		40/04, 41/08	33,000	Arts and Music		6,100
	East Stroudsburg	Information Commons Construction, Phase 2	OF&E			Mixed Usage		2,800
	Edinboro	Maintenance Building Replacement	OF&E	83/06, 82/10	1,650	Administration		1,700
	Indiana	Stapleton/Stabley Library Renovation/Addition		131/02	6,200	Libraries		6,200
		Weyandt/Walsh Hall Renovation or Replacement, Phase 2 (Construction)		82/10	90,000	Science and Technology		19,700
	Kutztown	Keystone Hall/Fieldhouse Upgrade		40/04, 41/08	21,034	Athletics		20,000
	Lock Haven	Electrical Infrastructure Renovation				Utilities Infrastructure		9,100
		South Ulmer Hall Renovation	OF&E	131/02	813	General Education		800
	Shippensburg	Henderson Hall Replacement		83/06	13,500	Athletics		6,900
	Slippery Rock	McKay Building Renovation/Addition	OF&E	82/10	2,000	General Education		1,200
2015/16 Total								\$129,600
Grand Total								\$655,867

Agency: Pennsylvania State System of Higher Education Capital Budget Authorization Request Departmental Summary of Requests (Dollars in Thousands) Public Improvement Projects		Source of Funds	Agency Request	OB Recommended	Difference
		Bond.....	\$186,500	\$0	\$0
		Current.....	0	0	0
		Federal.....	0	0	0
		Local.....	0	0	0
		Other.....	0	0	0
		Total.....	\$186,500	\$0	\$0
Priority No.	Project Title/Comments	Location	Source of Funds	Agency Request	OB Recommended
(1)	(2)		(3)	(4)	(5)
1	South Ulmer Hall Renovation (Additional Funds)	Lock Haven	B	\$23,000	
2	Franklin Science Center Renovation (Additional Funds)	Shippensburg	B	25,000	
3	New Facilities Complex Construction	Bloomsburg	B	19,000	
4	Electrical Infrastructure Renovation	Lock Haven	B	16,000	
5	Stapleton/Stabley Library Renovation/Addition (Additional Funds)	Indiana	B	14,500	
6	Sturzebecker Health Science Center Renovation/Addition (Additional Funds)	West Chester	B	13,000	
7	Henderson Hall Replacement (Additional Funds)	Shippensburg	B	11,000	
8	Russell Hall Renovation	Lock Haven	B	15,000	
9	Beeky Education Building Renovation (Additional Funds)	Kutztown	B	9,000	
10	Pucillo Hall Renovation	Millersville	B	7,000	
11	Brooks Hall Renovation	Millersville	B	15,000	
12	Coppin Hall Renovation	Cheyney	B	9,000	
13	Belknap and Retan Halls Renovation	Mansfield	B	10,000	
TOTAL			\$186,500	\$0	

Agency:	Pennsylvania State System of Higher Education Capital Budget Authorization Request Departmental Summary of Requests (Dollars in Thousands)	Source of Funds	Agency Request	OB Recommended	Difference
		Bond.....	\$33,800	\$0	\$0
		Current.....	0	0	0
		Federal.....	0	0	0
		Local.....	0	0	0
		Other.....	0	0	0
		Total.....	\$33,800	\$0	\$0
		Original Furniture and Equipment			
Priority No.	Project Title/Comments	Location	Source of Funds	Agency Request	OB Recommended
(1)	(2)		(3)	(4)	(5)
1	Educational Building (Lytle Hall) Demolition and Replacement/Expansion	Kutztown	B	\$3,000	
2	Coover Hall Renovation	California	B	1,500	
3	Information Commons Construction, Phase 2	East Stroudsburg	B	3,500	
4	New Student Housing Construction	Mansfield	B	2,000	
5	Cope Hall Renovation/Addition	Cheyney	B	5,000	
6	McCormick Center Renovation	Bloomsburg	B	2,500	
7	Stapleton/Stabley Library Renovation/Addition	Indiana	B	5,000	
8	Old Main and South Hall Renovation	California	B	3,500	
9	Student Success Center Renovation	Slippery Rock	B	2,800	
10	Poplar House Renovation/Addition	Kutztown	B	1,000	
11	Marwick Boyd Fine Arts Addition/Renovation	Clarion	B	4,000	
TOTAL				\$33,800	\$0

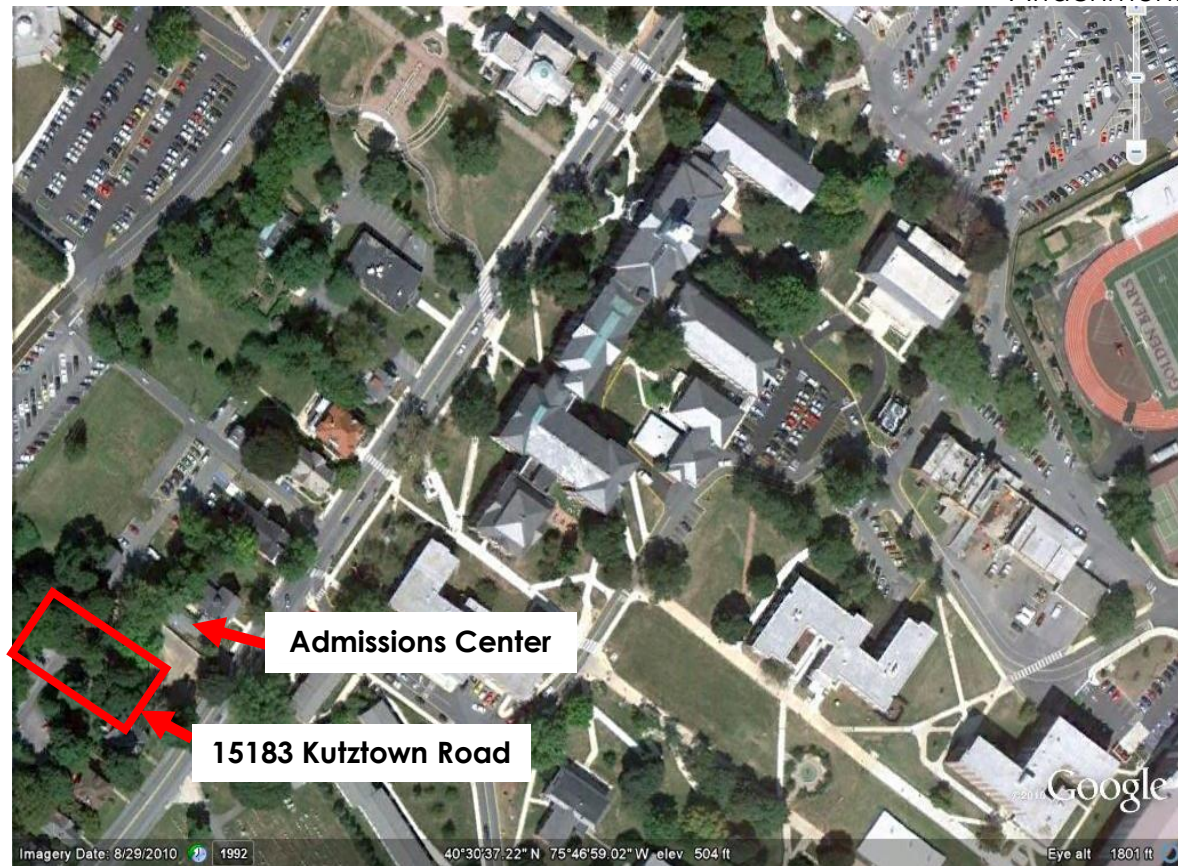

Kutztown University of Pennsylvania

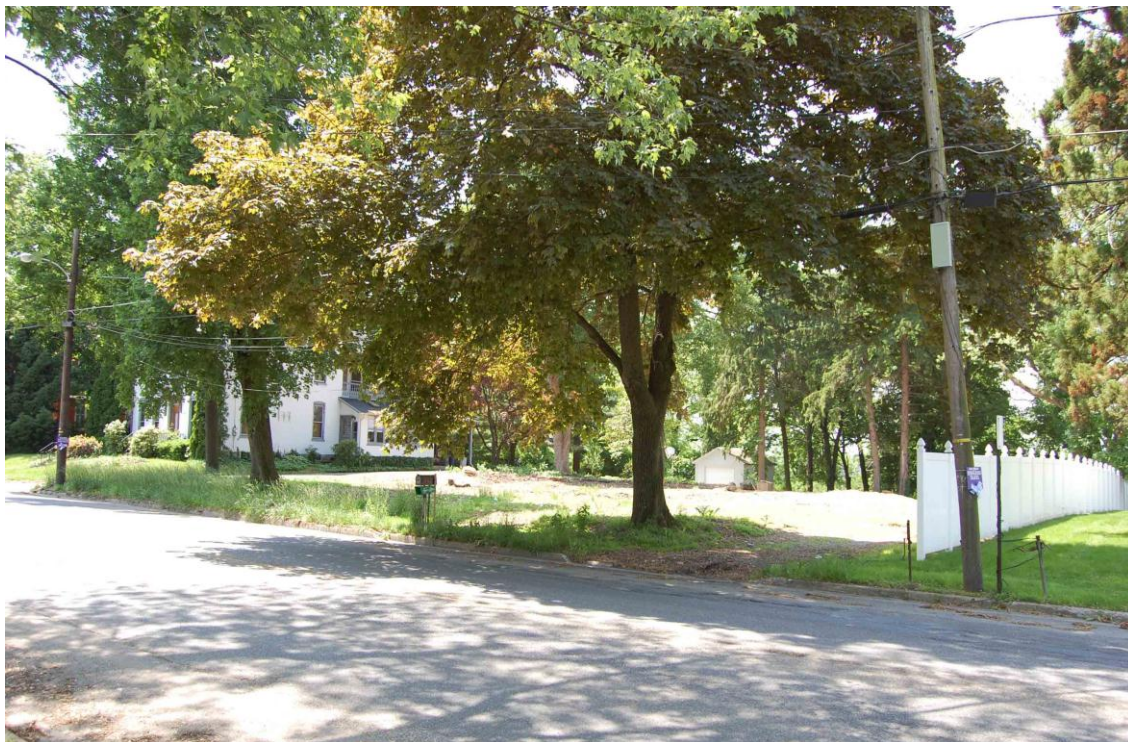

15183 Kutztown Road – Kutztown, Pennsylvania



Board of Governors' Meeting Calendar 2011-2014

Unless otherwise noted, all meetings will be held in the Administration Building, Dixon University Center, 2986 North Second Street, Harrisburg, Pennsylvania.

2011	Wednesday and Thursday Wednesday and Thursday	July 20 and 21 June 29 and 30 October 5 and 6
2012	Wednesday and Thursday Wednesday and Thursday Wednesday and Thursday Wednesday and Thursday	January 18 and 19 April 4 and 5 July 11 and 12 June 27 and 28 October 10 and 11
2013	Wednesday and Thursday Wednesday and Thursday Wednesday and Thursday Wednesday and Thursday	January 23 and 24 April 10 and 11 July 10 and 11 June 26 and 27 October 16 and 17
2014	Wednesday and Thursday Wednesday and Thursday Wednesday and Thursday Wednesday and Thursday	January 22 and 23 April 9 and 10 June 25 and 26 October 8 and 9

Revised: June 30, 2011